

Profipress with SC-Contur

Piping technology
copper/gunmetal

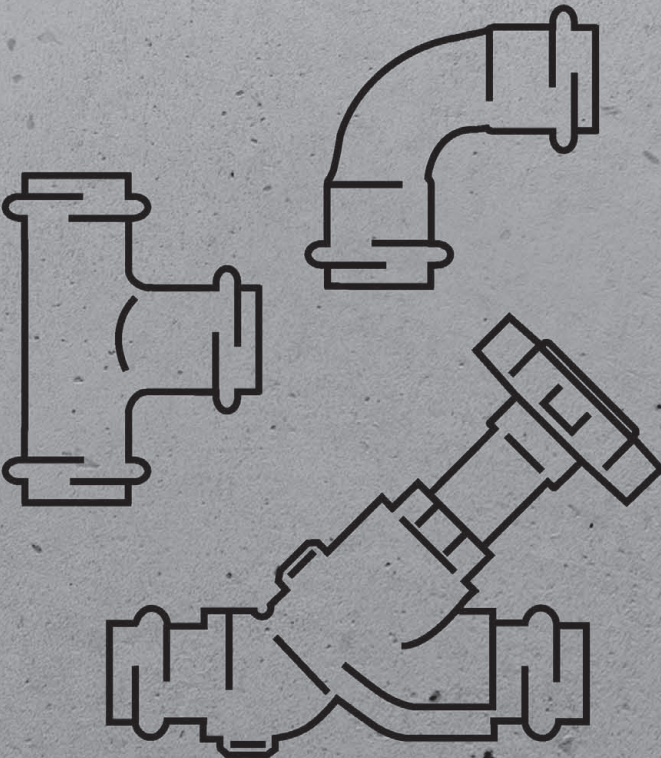

Press connector system with press connectors made of copper and gunmetal tested in acc. with DVGW worksheet W 534 with DVGW test seal and pipes made of copper in acc. with EN 1057 in acc. with DVGW worksheet GW 392. Suitable for drinking water installations in acc. with DIN 1988.

For dimensionally stable concealed and pre-wall installations of manifold and riser pipes in Viega component assembly.

Press connectors

All sizes with SC-Contur – connections, which remain unpressed become visible when the system is filled. The SC-Contur is certified and fulfils the requirements of DVGW worksheet W 534, point 12.14, connectors with forced leakage. During leakage tests with water, Viega guarantees the identification of unpressed connections in the pressure range 0.1 MPa–0.65 MPa, in the case of a dry leakage test with compressed air or noble gases from 22 hPa–0.3 MPa.

Marking

Green dot on the press connection

Sealing elements

EPDM, black (ethylene-propylene-dien-monomer rubber); up to 110 °C; not resistant against hydrocarbon solvent, chlorinated hydrocarbon solvents, turpentine, petrol

Dimensions/Material

Standard sizes: d 12; 15; 18; 22; 28; 35; 42; 54 made of copper
 XL sizes: d 64.0; 66.7; 76.1; 88.9; 108.0 made of copper
 XL sizes: d 76.1; 88.9; 108.0 made of gunmetal
 Press connectors with threaded connection made of gunmetal:
 d 12–54; 76.1–108.0
 Press connectors with threaded connection made of copper:
 d 64.0

Areas of application

Drinking water
 Heating/Radiator connection
 Rainwater
 Compressed air, noble gases
 Cooling water pipelines
 Industry
 Plant engineering

Special applications

with EPDM sealing element, factory-fitted

- stationary sprinkler-extinguishing systems - with VdS certificate G 4980009 for the sizes DN20-DN50 in connection with copper pipes in acc. with EN 1057 R290 (hard)

- Solar systems with flat collectors

with FKM sealing element (accessories)

- Solar systems with flat/vacuum collectors

- District heat suppliers and low pressure steam systems

Use of the system for application areas and media other than those described here must be agreed with Viega Service Center.

Operating conditions

Drinking water installations

- Operating temperature max. 85 °C
- Operating pressure max. 1.6 MPa

Heating installations

- Operating temperature max. 110 °C
- Operating pressure max. 1.6 MPa

Note

Observe flow direction!

Components made of copper may not be installed upstream from galvanised ferrous materials!

Note – Limitations of use drinking water

(related to the material - except components as fittings, instruments etc.)

Pipes made of copper may only be used when the pH value of the drinking water is $\text{pH} \geq 7.4$ or the total volume of organic

carbon does not exceed $\text{TOC}_{\text{max}} = 1.5 \text{ mg/l}$ at values between $\text{pH} = 7.0\text{-}7.4!$

Note – Limitations of use heating systems

Observe VDI 2035 and EN 12828!

Certification

Profipress (d 12–54)

- DVGW-Reg.-No. DW-8511BQ0586

Profipress XL (d 64.0)

- DVGW-Reg.-No. DW-8511BQ0586

Use of press tools

The functional safety of the Viega press connector systems is primarily dependent on the perfect condition of the press tools and press machines used. For this reason, for the production of press connections, we recommend the use of Viega press tools and their regular inspection by authorised service points.

Technical data

Press connectors and components are constantly being optimised. If required, the current Z and installation dimensions can be obtained from the download area of the Viega homepage: viega.com

Accessories for use with Easytop fittings, see product area system fittings.

INDEX

Elbows	4
T-pieces	7
Adapter pieces/adaptor elbows	13
Couplings	19
Reductions	21
Screw fittings	23
Caps, plugs	26
Flanges	27
Wall plates	29
Wall lead-ins	33
Compensators	33
Gunmetal ball valves	34
Free-flow valves	35
Concealed free-flow valves, concealed straight seat valves	35
Manifolds, cross pieces	36
Radiator connections	37
Skirting board radiator connection pieces	40

GTIN-Code (Global Trade Item Number, previously EAN-Code)

The GTIN-Code composed out of the constant manufacturer number 4015211 and a six-digit article code - in this example 305 611. The exchange of the last six digits against the article code shows the GTIN-Code.

ELBOWS

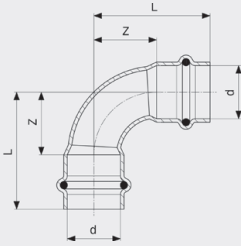

Profipress Elbow 90°
- copper
Model 2416

article	d	L	Z	L*	Z*
291 488	12	32	14		
443 863	14	36	17		
291 501	15	38	16	40	18
443 870	16	38	19		
291 495	18	40	18	44	22
291 518	22	49	26	42	19
291 525	28	55	31	58	34
291 532	35	59	33	68	42
291 549	42	69	33	86	50
291 556	54	95	55	105	65

L* = length of the previous version
Z* = previous version

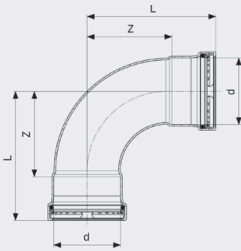

Profipress XL Elbow 90°
- copper
Model 2416XL

article	d	Z	L
577 681	64.0	84	126
645 137	66.7	81	124
476 847	76.1	99	149
476 854	88.9	114	164
476 861	108.0	138	198

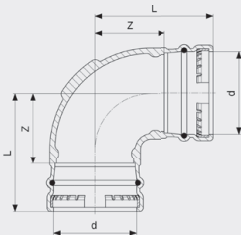

Sanpress XL Elbow 90°
- gunmetal
Model 2216XL

article	d	Z	L	Z*	L*
350 697	76.1	44	97	68	114
350 680	88.9	67	120	49	102
350 703	108.0	77	140		

Z* = previous version
L* = length of the previous version

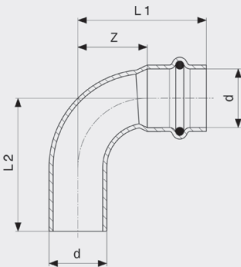

Profipress Elbow 90°
- copper
Model 2416.1

article	d	Z	L1	L2	Z*	L1*	L2*
291 648	12	14	32	34			
444 099	14	17	36	37			
291 662	15	16	38	41	18	40	41
444 105	16	19	38	39			
291 655	18	18	40	42	22	44	44
291 679	22	26	49	51	19	42	47
291 686	28	31	55	60	34	58	60
291 693	35	33	59	63	42	68	70
291 709	42	33	69	71	50	86	88
291 716	54	55	95	96	65	105	107

Z* = previous version
L* = length of the previous version

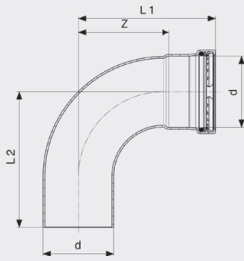

Profipress XL Elbow 90°
- copper
Model 2416.1XL

article	d	Z	L1	L2
577 698	64.0	84	126	126
648 350	66.7	81	124	122
476 878	76.1	99	149	146
476 885	88.9	114	164	162
476 892	108.0	138	198	195

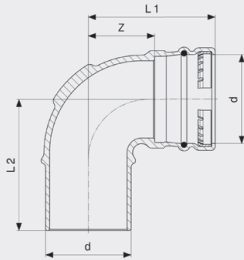

Sanpress XL Elbow 90°
- gunmetal
Model 2216.1XL

article	d	Z	L1	L2	Z*	L1*	L2*
353 650	76.1	44	97	112	61	114	118
353 667	88.9	67	120	125			
353 674	108.0	77	140	145			

Z* = previous version
L* = length of the previous version

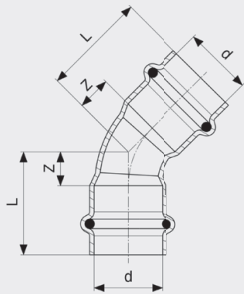

Profipress Elbow 45°
- copper
Model 2426

article	d	Z	L	Z*	L*
292 409	12	6	24		
444 051	14	7	26		
292 348	15	7	29	8	30
444 068	16	8	26		
292 416	18	7	29	9	31
292 355	22	11	34	9	32
292 362	28	12	36	14	38
292 379	35	15	41	17	43
292 386	42	17	53	21	57
292 393	54	22	62	27	67

Z* = previous version
L* = length of the previous version

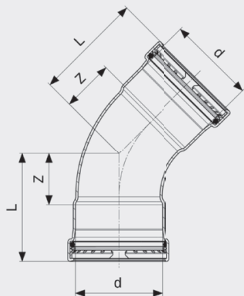

Profipress XL Elbow 45°
- copper
Model 2426XL

article	d	Z	L
577 766	64.0	39	82
645 144	66.7	38	81
476 908	76.1	46	96
476 915	88.9	52	102
476 922	108.0	61	121

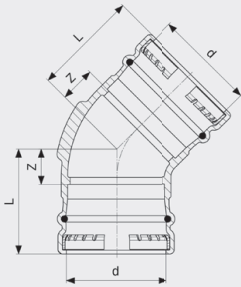

Sanpress XL Elbow 45°
- gunmetal
Model 2226XL

article	d	Z	L
351 342	76.1	30	83
351 359	88.9	32	85
351 366	108.0	36	99

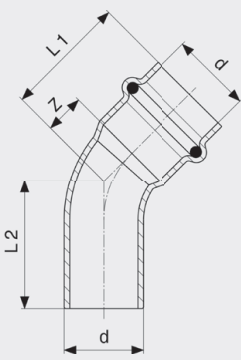

Profipress Elbow 45°
- copper
Model 2426.1

article	d	Z	L1	L2	Z*	L1*	L2*
292 577	12	6	24	26			
444 112	14	7	26	27			
292 508	15	7	29	29	8	30	31
444 129	16	8	26	28			
292 560	18	7	29	30	9	31	32
292 515	22	11	34	36	9	32	34
292 522	28	12	36	40	14	38	40
292 539	35	15	41	42	17	43	45
292 546	42	17	53	52	21	57	59
292 553	54	22	62	64	27	67	71

Z* = previous version
L* = length of the previous version

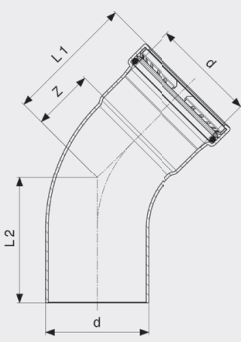

Profipress XL Elbow 45°
- copper
Model 2426.1XL

article	d	Z	L1	L2
577 773	64.0	39	82	82
648 367	66.7	38	81	79
476 939	76.1	46	96	92
476 946	88.9	52	102	99
476 953	108.0	57	117	115

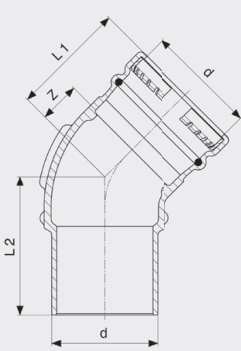

Sanpress XL Elbow 45°
- gunmetal
Model 2226.1XL

article	d	Z	L1	L2
353 681	76.1	29	83	100
353 698	88.9	32	85	104
353 704	108.0	36	99	128

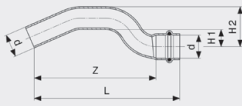

Profipress Crossover
- copper
Model 2427

article	d	Z	L	H1	H2
322 359	12	81	99	12	24
322 342	15	93	115	12	27
322 335	18	98	120	13	31
322 328	22	118	141	17	39

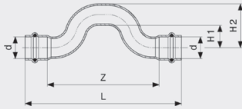

Profipress Crossover
- copper
Model 2428

article	d	Z	L	H1	H2
352 134	15	90	134	20	35
352 141	18	100	144	20	38
352 158	22	115	161	23	45

T-PIECES

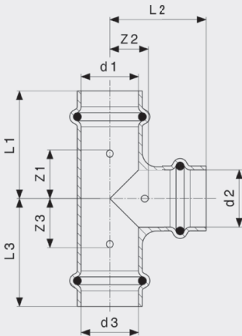

Profipress T-piece
- copper
Model 2418

article	d1	d2	d3	Z1	Z2	Z3	L1	L2	L3
291 884	12	12	12	18	9	18	36	27	36
322 717	12	15	12	20	10	20	38	32	38
443 900	14	12	14	17	12	17	36	30	36
443 887	14	14	14	18	12	18	37	31	37
291 907	15	12	12	16	12	20	38	30	38
291 914	15	12	15	16	12	16	38	30	38
315 085	15	15	12	18	11	22	40	33	40
291 952	15	15	15	18	11	18	40	33	40
322 724	15	18	15	20	13	20	42	35	42
322 700	15	22	15	22	15	22	44	38	44
443 917	16	12	14	21	12	18	40	30	36
443 924	16	14	16	18	13	18	37	32	37
443 894	16	16	16	19	13	19	38	32	38
365 073	18	12	15	16	13	21	38	31	43
324 827	18	12	18	16	13	16	38	31	38
443 931	18	14	18	18	15	18	40	34	40
291 921	18	15	15	18	13	23	40	35	45
291 938	18	15	18	10	13	10	40	35	40
443 948	18	16	18	19	15	19	41	34	41
315 009	18	18	15	20	13	24	42	35	46
291 891	18	18	18	20	13	20	42	35	42
322 694	18	22	18	22	13	22	44	36	44
324 834	22	12	22	16	15	16	38	33	38
443 955	22	14	22	17	17	17	40	36	40
292 010	22	15	15	17	15	25	40	37	47
315 078	22	15	18	17	15	22	40	37	44
292 027	22	15	22	8	15	8	40	37	40
443 962	22	16	22	18	17	18	41	36	41
315 061	22	18	15	19	15	28	42	37	50
315 054	22	18	18	19	15	25	42	37	47
291 945	22	18	22	19	15	19	42	37	42
315 047	22	22	15	21	15	29	44	38	51

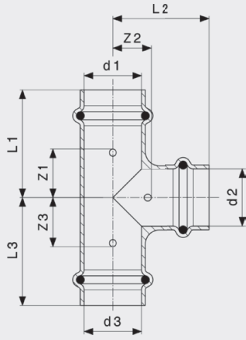

Profipress T-piece
- copper
Model 2418

article	d1	d2	d3	Z1	Z2	Z3	L1	L2	L3
315 030	22	22	18	21	15	29	44	38	51
291 969	22	22	22	22	15	22	44	38	44
322 687	22	28	22	24	15	24	48	39	48
324 841	28	15	22	16	19	22	40	41	46
295 189	28	15	28	16	19	16	40	41	40
324 858	28	18	22	18	19	24	42	41	47
315 023	28	18	28	18	19	18	42	41	42
307 899	28	22	22	20	19	26	44	42	50
295 196	28	22	28	13	19	13	44	42	44
315 016	28	28	22	20	19	30	48	43	52
291 976	28	28	28	23	19	23	48	43	48
324 865	35	15	35	17	22	17	44	44	44
324 872	35	18	35	18	22	18	44	44	44
324 889	35	22	28	19	22	28	46	45	52
292 034	35	22	35	19	22	19	46	45	46
324 896	35	28	28	22	22	32	48	46	56
292 041	35	28	35	22	22	22	48	46	48
365 882	35	35	22	26	22	40	52	48	63
365 080	35	35	28	26	22	35	52	48	59
291 983	35	35	35	26	22	26	52	48	52
324 902	42	22	42	17	29	17	53	52	53
292 058	42	28	42	19	29	19	55	53	55
292 065	42	35	42	22	29	22	58	55	58
291 990	42	42	42	29	29	29	65	65	65
324 919	54	22	54	19	35	19	60	58	60
324 926	54	28	54	22	35	22	62	59	62
324 933	54	35	54	26	35	26	66	61	66
292 072	54	42	54	29	35	29	69	71	69
292 003	54	54	54	35	35	35	75	75	75

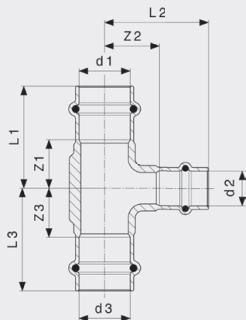

Sanpress T-piece
- gunmetal
Model 2218

article	d1	d2	d3	Z1	Z2	Z3	L1	L2	L3
314 132	28	28	15	28	28	26	52	52	48
314 163	28	28	18	28	28	27	52	52	49
314 224	42	15	42	23	34	23	59	56	59
283 551	42	35	35	29	36	31	65	62	56
187 279	54	42	42	37	39	34	77	75	70

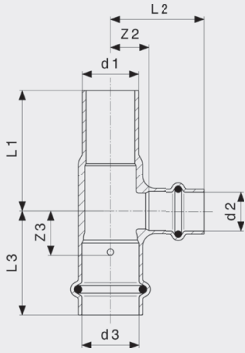

Profipress T-piece
- copper
Model 2418.1

article	d1	d2	d3	Z2	Z3	L1	L2	L3
477 356	22	15	22	15	12	48	37	40

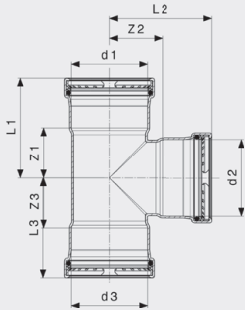

Profipress XL T-piece
- copper
Model 2418XL

article	d1	d2	d3	Z1	Z2	Z3	L1	L2	L3
577 735	64.0	35	64.0	32	43	32	74	70	74
577 742	64.0	42	64.0	35	43	35	78	79	78
577 759	64.0	54	64.0	41	42	41	84	82	84
577 728	64.0	64.0	64.0	46	49	46	90	82	90
648 411	66.7	28	66.7	26	44	26	70	68	70
648 381	66.7	35	66.7	32	43	32	74	69	74
648 404	66.7	42	66.7	33	46	33	76	82	76
648 398	66.7	54	66.7	39	45	39	82	85	82
648 374	66.7	66.7	66.7	46	48	46	90	91	90
476 977	76.1	54	76.1	40	48	40	90	88	90
719 234	76.1	66.7	76.1	51	54	51	101	97	101
476 960	76.1	76.1	76.1	50	54	50	100	104	100
476 991	88.9	54	88.9	40	54	40	90	95	90
477 004	88.9	76.1	88.9	50	59	50	100	109	100
476 984	88.9	88.9	88.9	57	59	57	107	109	107
477 028	108.0	54	108.0	40	66	40	100	106	100
477 035	108.0	76.1	108.0	52	70	52	112	120	112
477 042	108.0	88.9	108.0	58	70	58	118	120	118
477 011	108.0	108.0	108.0	68	72	68	128	132	128

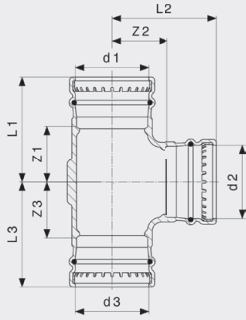

Sanpress XL T-piece
- gunmetal
Model 2218XL

article	d1	d2	d3	Z1	Z2	Z3	L1	L2	L3
354 398	76.1	54	76.1	47	65	47	100	105	100
350 628	76.1	76.1	76.1	61	61	61	114	114	114
354 404	88.9	54	88.9	46	70	46	100	110	100
354 411	88.9	76.1	88.9	62	67	62	115	120	115
350 635	88.9	88.9	88.9	67	67	67	120	120	120
354 428	108.0	54	108.0	47	80	47	110	120	110
354 435	108.0	76.1	108.0	62	77	62	125	130	125
354 442	108.0	88.9	108.0	67	77	67	130	130	130
350 642	108.0	108.0	108.0	77	77	77	140	140	140

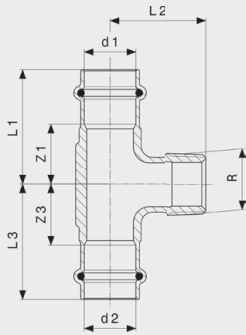

Sanpress T-piece
- gunmetal
Model 2217.1

article	d1	R	d2	Z1	Z3	L1	L2	L3
281 328	18	3/4	18	23	23	45	40	45
194 123	22	3/4	22	26	26	50	42	50
194 130	28	3/4	28	26	26	50	45	50
194 147	35	3/4	35	24	24	50	45	50
273 231	42	3/4	42	19	19	55	50	55
197 858	54	3/4	54	26	26	66	55	66
310 929	54	1	54	29	29	69	63	69
310 936	54	1 1/4	54	32	32	72	66	72

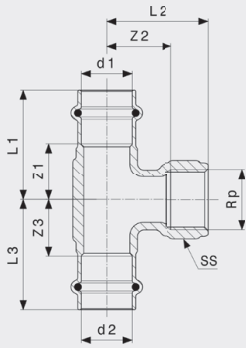

Sanpress T-piece
- gunmetal
Model 2217.2

article	d1	Rp	d2	Z1	Z2	Z3	L1	L2	L3	SS	Z1*	Z2*	Z3*	L1*	L2*	L3*
290 986	12	1/2	12	22	22	22	40	35	40	26						
313 951	15	3/8	15	21	21	21	43	35	43	22						
115 630	15	1/2	15	19	11	19	41	21	41		23	9	23	45	21	45
281 359	18	1/2	18	18	8	18	40	24	40	26	23	25	23	45	40	45
115 944	22	1/2	22	19	13	19	42	28	42	26	25	28	25	48	42	48
313 975	22	3/4	22	25	29	25	48	45	48	32						
119 768	28	1/2	28	21	17	21	45	32	45	26	25	30	25	48	46	48
313 968	28	3/4	28	29	34	29	52	50	52	32						
121 945	35	1/2	35	19	20	19	45	35	45	26	23	34	23	48	49	48
361 204	35	1	35	34	36	34	60	55	60	39						
126 230	42	1/2	42	19	35	19	55	50	55	28						
361 211	42	1	42	29	40	29	65	59	65	39						
197 353	54	1/2	54	26	40	26	66	55	66	28						
361 228	54	1	54	30	47	30	70	66	70	39						

SS = wrench size

Z* = Z-dimension of the previous version

L* = length of the previous version

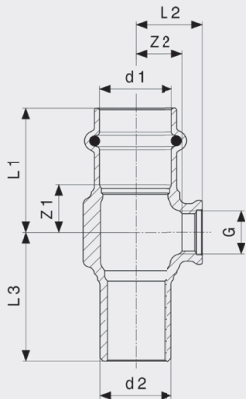

Sanpress T-piece, G¹/₄, with plug-in end
- gunmetal
Model 2217.4

article	d1	G	d2	Z1	Z2	L1	L2	L3
705 596	15	1/4	15	14	11	36	18	38
705 602	18	1/4	18	14	12	36	18	38
705 619	22	1/4	22	14	14	38	20	40
705 626	28	1/4	28	16	17	40	24	41
705 633	35	1/4	35	14	21	40	28	44
705 640	42	1/4	42	16	26	52	32	61
705 855	54	1/4	54	20	33	60	39	65

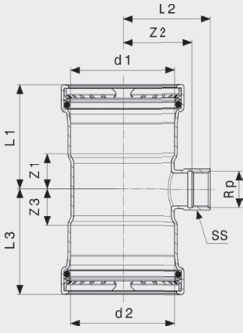

Profipress XL T-piece
- copper
Model 2417.2XL

article	d1	d2	Rp	Z1	Z2	Z3	L1	L2	L3	SS
577 704	64.0	64.0	¾	27	42	27	70	58	70	30
577 711	64.0	64.0	1	32	51	32	74	63	74	38
534 073	76.1	76.1	¾	26	48	26	76	64	76	30
534 080	76.1	76.1	2	40	48	40	90	74	90	65
534 097	88.9	88.9	¾	26	54	26	76	70	76	30
534 103	88.9	88.9	2	40	53	40	90	79	90	65
534 110	108.0	108.0	¾	28	64	28	88	80	88	30
534 127	108.0	108.0	2	40	64	40	100	90	100	65

SS = wrench size

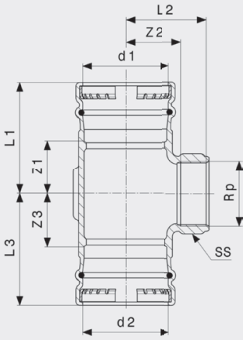

Sanpress XL T-piece
- gunmetal
Model 2217.2XL

article	d1	Rp	d2	Z1	Z2	Z3	L1	L2	L3	SS
354 572	76.1	¾	76.1	32	51	32	85	68	85	32
351 434	76.1	2	76.1	49	51	49	102	77	102	69
354 589	88.9	¾	88.9	32	58	32	85	74	85	32
351 441	88.9	2	88.9	49	57	49	102	83	102	69
354 596	108.0	¾	108.0	32	67	32	95	83	95	32
352 097	108.0	2	108.0	39	67	39	102	92	102	69

SS = wrench size

ADAPTER PIECES/ADAPTER ELBOWS

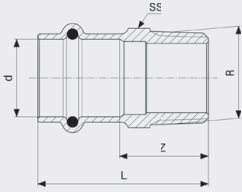

Sanpress Adapter
- gunmetal
Model 2211

article	d	R	Z	L	SS	Z*	L*	SS*
290 771	12	3/8	18	35	17	17	34	17
290 764	12	1/2	20	37	17	24	38	22
443 689	14	3/8	17	36	19			
443 696	14	1/2	22	41	22			
297 985	15	3/8	17	39	19			
105 044	15	1/2	24	46	19	22	44	22
287 764	15	3/4	28	50	22	26	48	27
443 702	16	1/2	22	41	22			
443 719	16	3/4	25	44	27			
283 490	18	1/2	22	44	22	21	43	22
283 230	18	3/4	27	49	22	25	47	27
297 961	22	1/2	25	49	27	22	45	27
104 306	22	3/4	26	49	27	27	50	27
287 771	22	1	33	56	30	32	55	34
297 954	28	3/4	28	52	33			
106 508	28	1	32	55	34			
297 978	28	1 1/4	34	58	34	38	62	42
297 947	35	1	28	53	40			
110 352	35	1 1/4	34	60	43	36	59	43
314 651	35	1 1/2	37	62	50	35	60	50
297 930	42	1 1/4	29	65	48			
115 340	42	1 1/2	30	66	50	31	67	50
314 668	54	1 1/2	38	78	68			
195 267	54	2	39	79	68			

SS = wrench size
Z* = previous version
L* = length of the previous version
SS* = previous version (spanner size)

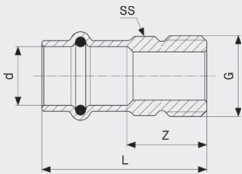

Sanpress Adapter
- gunmetal
Model 2211.4

article	d	G	Z	L	SS
660 222	15	1/2	21	43	19

SS = wrench size

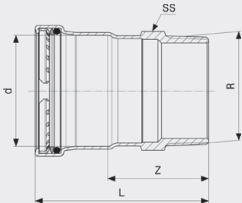

Profipress XL Adapter
- copper
Model 2411XL

article	d	R	Z	L	SS
577 674	64.0	2 1/2	70	113	77
648 510	66.7	2 1/2	68	111	77
534 134	76.1	2 1/2	70	120	77
534 141	88.9	3	74	124	90
534 158	108.0	4	86	146	115

SS = wrench size

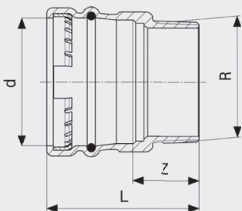

Sanpress XL Adapter
- gunmetal
Model 2211XL

article	d	R	Z	L
350 659	76.1	2 1/2	42	95
350 666	88.9	3	47	100
350 673	108.0	4	45	110

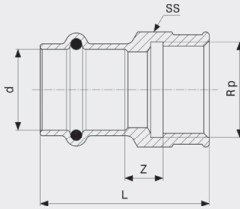

Sanpress Adapter
- gunmetal
Model 2212

article	d	Rp	Z	L	SS
291 075	12	3/8	3	32	20
291 068	12	1/2	6	39	26
443 726	14	1/2	7	41	26
298 074	15	3/8	4	37	20
107 543	15	1/2	7	44	26
298 098	15	3/4	7	45	30
443 733	16	1/2	7	41	26
283 483	18	1/2	6	43	26
294 519	18	3/4	7	45	30
298 067	22	1/2	6	44	26
108 465	22	3/4	7	47	30
298 128	22	1	9	52	38
428 174	28	1/2	5	44	33
298 081	28	3/4	7	47	33
114 329	28	1	9	52	38
298 104	28	1 1/4	11	56	47
357 542	35	3/4	5	47	38
298 111	35	1	3	48	38
116 774	35	1 1/4	7	54	47
298 050	42	1 1/4	4	61	47
124 236	42	1 1/2	4	61	53
365 097	54	1 1/2	11	72	68
195 304	54	2	9	75	70

SS = wrench size

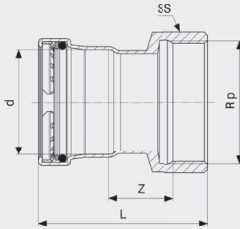

Profipress XL Adapter
- copper
Model 2412XL

article	d	Rp	Z	L	SS
577 667	64.0	2 1/2	31	104	82
648 527	66.7	2 1/2	24	97	82

SS = wrench size

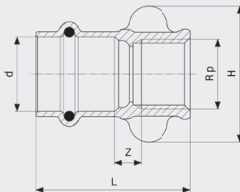

Sanpress Adapter
- gunmetal
Model 2212.3

article	d	Rp	Z	L	H
287 016	15	1/2	8	44	41
298 913	18	1/2	9	46	41
287 009	22	1/2	8	47	41

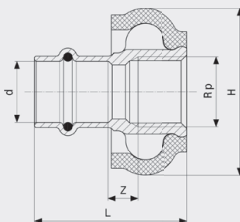

Sanpress Adapter
- gunmetal
Model 2212.4

article	d	Rp	Z	L	H
335 021*	18	1/2	9	46	50

* = Discontinued, limited availability

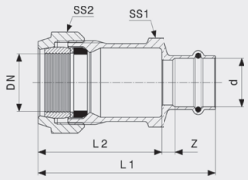

Sanpress Adapter
- gunmetal
Model 2215.6

article	DN	d	Z	L1	L2	SS1	SS2
588 564	25	28	8	104	72	50	55
588 328	32	35	8	112	78	68	70

SS = Spanner size
SS = spanner size

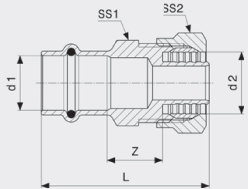

Sanpress Adapter
- gunmetal
Model 2213

article	d1	d2	L	Z	SS1	SS2
288 068	15	16	54	16	24	26
298 876*	15	20	58	20	27	30
298 883*	18	20	56	18	27	30

SS = Spanner size
SS = spanner size

* = Discontinued, limited availability

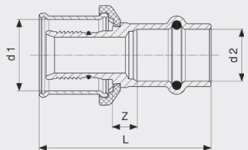

Sanfix P Adapter
- gunmetal
Model 2213P

article	d1	d2	L	Z
317 423	16	15	48	6
317 447	16	18	51	9
317 430	20	15	51	7
317 454	20	18	52	8
317 508	20	22	54	9
605 490	25	22	56	8
605 506	32	28	61	9
605 513*	40	28	64	10
605 520	40	35	65	10

* = Discontinued, limited availability

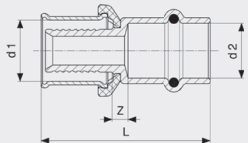

Profipress Adapter
- gunmetal
Model 1075.12P

article	d1	d2	Z	L
314 958	14	15	6	49

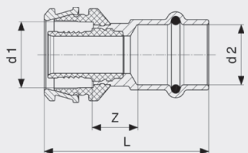

Raxofix Adapter
- gunmetal
Model 5313P

article	d1	d2	Z	L
646 707	16	15	13	50
646 714	16	18	14	51
646 721	20	15	13	50
646 738	20	18	14	50
646 745	20	22	15	53
646 752	25	22	16	59
646 769	32	28	15	58
646 776	40	28	21	71
646 783	40	35	19	70
646 790	50	35	24	76

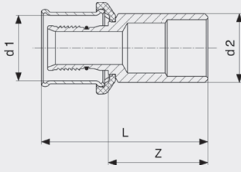

Sanfix P Plug-in piece
- gunmetal
Model 2113

article	d1	d2	Z	L
303 822	16	15	33	52
303 815	16	18	31	51
331 528	20	18	30	51
304 744	20	22	33	54
566 678	25	22	33	57
566 685	32	28	36	64
566 692	40	35	40	69
566 708	50	42	51	86

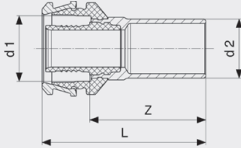

Raxofix Plug-in piece
- gunmetal
Model 5313

article	d1	d2	Z	L
646 554	16	15	36	51
646 561	16	18	37	52
646 578	20	18	36	50
646 585	20	22	39	54
646 592	25	22	40	60
646 608	32	28	41	61
646 615	40	35	47	74
646 622	50	42	62	88

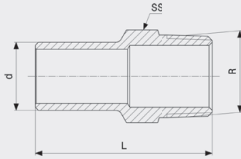

Sanpress Plug-in piece
- gunmetal
Model 2211.1

article	d	R	L	SS
291 310	12	1/2	47	22
115 418	15	1/2	49	22
285 081	18	1/2	50	22
285 104	18	3/4	56	28
119 676	22	1/2	53	22
116 767	22	3/4	58	28
122 034	28	1	62	34
125 288	35	1 1/4	62	43
132 231	42	1 1/2	78	50

SS = wrench size

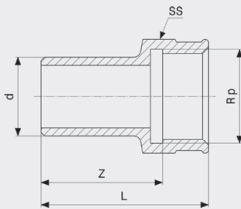

Sanpress Plug-in piece
- gunmetal
Model 2212.1

article	d	Rp	Z	L	SS
291 341	12	1/2	25	40	25
117 733	15	1/2	28	43	25
287 085	18	1/2	28	43	25
287 108	18	3/4	29	45	30
120 917	22	1/2	30	45	25
117 481	22	3/4	31	47	30
130 954	28	3/4	31	47	30
122 942	28	1	32	51	38
134 730	35	1	37	56	38
130 589	35	1 1/4	40	61	47
135 430	42	1 1/2	53	74	53
199 104	54	2	59	85	70

SS = wrench size

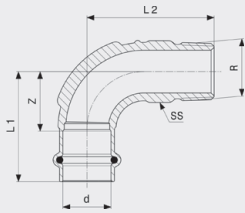

Sanpress Adapter elbow 90°
- gunmetal
Model 2214

article	d	R	Z	L1	L2	SS	Z*	L1*	L2*
290 863	12	3/8	19	36	40	15			
290 870	12	1/2	19	36	44	17			
444 006	14	1/2	21	40	45	21			
314 361	15	3/8	23	45	47	17			
112 950	15	1/2	16	38	34	19	23	45	43
443 030	15	3/4	29	51	59	27			
444 013	16	1/2	22	41	45	21			
281 205	18	1/2	24	46	50	21			
314 354	18	3/4	24	46	55	27			
115 623	22	3/4	28	51	59	27			
118 730	28	1	34	58	72	36			
127 329	35	1 1/4	48	74	88	44			
128 500	42	1 1/2	29	65	60	45	56	92	98
197 988	54	2	70	110	120	61			

SS = wrench size

Z* = previous version

L* = length of the previous version

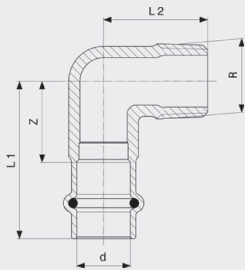

Sanpress Adapter elbow 90°
- gunmetal
Model 2214.1

article	d	R	Z	L1	L2
335 281	15	1/2	23	45	30

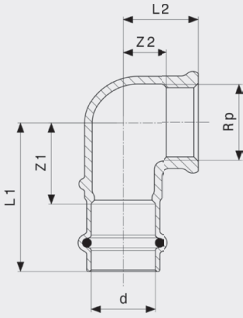

Sanpress Adapter elbow 90°
- gunmetal
Model 2214.2

article	d	Rp	Z1	Z2	L1	L2	Z1*	Z2*	L1*	L2*
290 924	12	3/8	20	5	38	16				
290 931	12	1/2	22	5	40	20				
444 020	14	1/2	25	7	44	22				
298 241	15	3/8	24	7	46	18				
108 441	15	1/2	22	7	44	22	24	12	46	22
314 385	15	3/4	28	8	50	24				
444 037	16	1/2	25	7	44	22				
281 236	18	1/2	24	7	46	22				
298 227	18	3/4	28	8	50	24				
298 234	22	1/2	28	10	52	26				
283 711	22	3/4	28	10	52	26				
314 378	22	1	36	10	59	29				
442 033	28	1/2	32	17	56	32				
446 611	28	3/4	34	10	58	26				
283 728	28	1	36	13	59	32				
283 704	35	1 1/4	40	17	66	38				
299 415	42	1 1/2	41	22	77	43				
299 422	54	2	57	29	97	55				

Z* = Z-dimension of the previous version
L* = length of the previous version

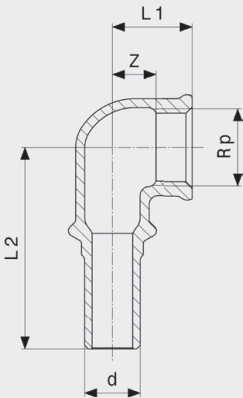

Sanpress Plug-in elbow 90°
- gunmetal
Model 2214.3

article	d	Rp	Z	L1	L2
308 001	15	1/2	7	22	55

COUPLINGS

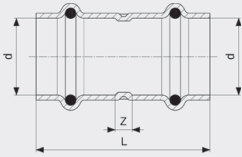

Profipress Coupling
- copper
Model 2415

article	d	Z	L
292 737	12	3	39
443 740	14	3	41
292 690	15	3	47
443 856	16	3	41
292 744	18	5	49
292 683	22	5	51
292 676	28	4	52
292 706	35	4	56
292 713	42	4	76
292 720	54	4	84

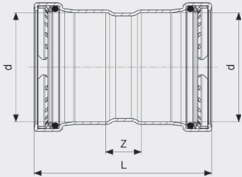

Profipress XL Coupling
- copper
Model 2415XL

article	d	Z	L
577 582	64.0	24	110
648 435	66.7	24	110
477 059	76.1	25	125
477 066	88.9	25	125
477 073	108.0	27	147

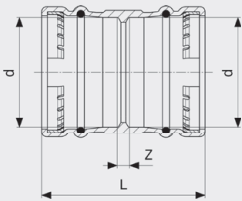

Sanpress XL Coupling
- gunmetal
Model 2215XL

article	d	Z	L
350 598	76.1	9	115
350 604	88.9	9	115
350 611	108.0	9	135

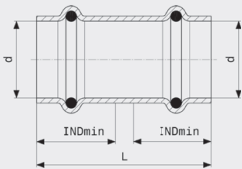

Profipress Sliding coupling
- copper
Model 2415.3

article	d	L	INDmin
713 416	12	39	18
461 256	15	47	22
461 263	18	49	22
461 270	22	51	23
461 287	28	52	24
461 294	35	56	26
461 317	42	76	36
461 300	54	84	40

INDmin = insertion depth minimum

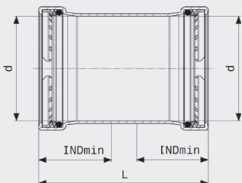

Profipress XL Sliding coupling
- copper
Model 2415.5XL

article	d	L	INDmin
577 650	64.0	110	43
648 442	66.7	110	43
477 080	76.1	125	50
477 097	88.9	125	50
477 103	108.0	147	60

INDmin = insertion depth minimum

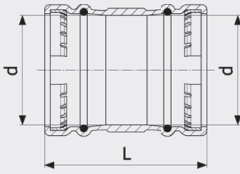

Sanpress XL Sliding coupling
- gunmetal
Model 2215.5XL

article	d	L	INDmin
353 315	76.1	115	55
353 322	88.9	115	55
353 339	108.0	135	65

INDmin = insertion depth minimum

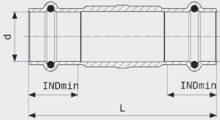

Sanpress Sliding coupling
- gunmetal
Model 2215.5

article	d	L	INDmin
119 485	15	80	22
287 061	18	80	22
119 041	22	85	24
122 133	28	95	24
124 335	35	105	26
131 494	42	120	36
216 153	54	135	40

INDmin = insertion depth minimum

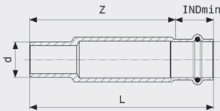

Sanpress Sliding coupling
- gunmetal
Model 2215.4

article	d	Z	L	INDmin
588 533	22	92	115	24
588 540	28	102	125	24
588 557	35	110	135	26

INDmin = insertion depth minimum

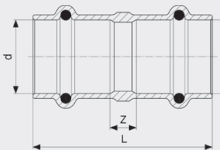

Sanpress Coupling
- gunmetal
Model 9777.9

article	d	Z	L
335 946 ¹⁾	10	5	40

¹⁾ Press connection d10 should be carried out with a size 12 press jaw!

REDUCTIONS

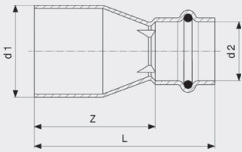

Profipress Reducer
- copper
Model 2415.1

article	d1	d2	Z	L
443 771	14	12	24	42
296 414	15	12	32	50
443 788	16	12	30	48
443 795	16	14	24	43
298 586	18	12	35	53
443 801	18	14	33	52
296 407	18	15	32	54
443 818	18	16	27	46
443 825	22	14	36	55
296 377	22	15	36	58
443 832	22	16	36	55
296 391	22	18	33	55
296 469	28	15	43	65
296 384	28	18	39	61
296 506	28	22	29	52
296 452	35	22	46	69
296 490	35	28	39	63
296 445	42	22	69	92
296 483	42	28	63	87
296 476	42	35	56	82
366 476	54	28	79	103
296 438	54	35	71	97
296 421	54	42	64	100

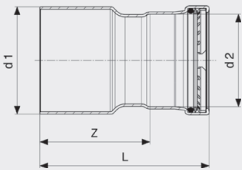

Profipress XL Reducer
- copper
Model 2415.1XL

article	d1	d2	Z	L
577 605	64.0	42	67	103
577 612	64.0	54	60	100
648 473	66.7	28	91	115
648 480	66.7	35	88	114
648 466	66.7	42	88	124
648 459	66.7	54	58	98
477 110	76.1	54	91	132
587 505	76.1	64.0	92	135
719 241	76.1	66.7	77	120
477 127	88.9	54	98	139
648 503	88.9	66.7	96	139
477 134	88.9	76.1	91	141
477 141	108.0	54	118	158
648 497	108.0	66.7	114	157
477 158	108.0	76.1	111	161
477 165	108.0	88.9	104	154

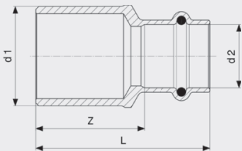

Sanpress Reducer
- gunmetal
Model 2215.1

article	d1	d2	Z	L	Z*	L*
366 865	22	12	28	45	26	43

Z* = previous version
L* = length of the previous version

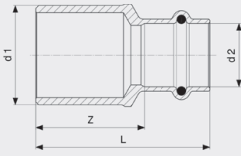

Sanpress Reducer
- gunmetal
Model 2215.1NC

article	d1	d2	Z	L
323 707 ¹	15	14	28	52
323 714 ²	15	16	30	53
323 721 ²	18	16	30	53

¹) Press connection d14 should be carried out with a size 15 press jaw!

²) Press connection d16 should be carried out with a size 18 press jaw!

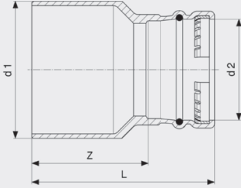

Sanpress XL Reducer
- gunmetal
Model 2215.1XL

article	d1	d2	Z	L
354 664	76.1	54	81	121
354 671	88.9	54	86	126
354 688	88.9	76.1	72	125
354 695	108.0	54	106	146
354 701	108.0	76.1	92	145
354 718	108.0	88.9	87	140

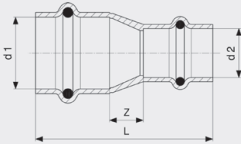

Profipress Reducing coupling
- copper
Model 2415.2

article	d1	d2	Z	L
325 770	15	12	8	48
325 787	18	15	7	53
325 794	22	15	10	56
325 800	22	18	9	54
325 817	28	22	11	58
328 269	35	28	13	63
328 252	42	35	13	75
328 276	54	42	19	95

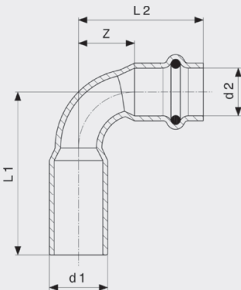

Profipress Reducing elbow 90°
- copper
Model 2416.2

article	d1	d2	Z	L1	L2
629 281	15	12	14	32	42

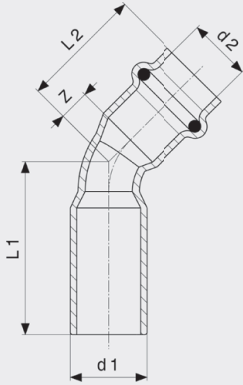

Profipress Reducing elbow 45°
- copper
Model 2426.2

article	d1	d2	Z	L1	L2
629 298*	15	12	6	34	24

* = Discontinued, limited availability

SCREW FITTINGS

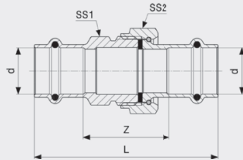

Sanpress Screw fitting
- gunmetal
Model 2260

article	d	Z	L	SS1	SS2
293 017	12	30	65	25	30
126 148	15	33	77	25	30
287 436	18	36	80	24	30
126 124	22	42	89	31	37
124 311	28	48	94	40	46
130 947	35	48	100	45	53
132 446	42	49	121	50	60
226 329	54	53	133	70	78

SS = Spanner size
SS = spanner size

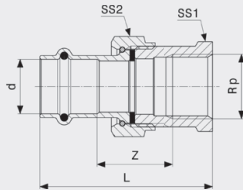

Sanpress Adapter union
- gunmetal
Model 2262

article	d	Rp	Z	L	SS1	SS2
293 024	12	1/2	23	56	27	30
131 937	15	1/2	26	62	27	30
133 160	15	3/4	31	66	30	30
283 384	18	1/2	28	65	27	30
314 910	18	3/4	33	68	30	30
125 318	22	3/4	32	72	34	37
133 900	22	1	42	78	40	37
365 103	28	3/4	22	62	32	46
128 975	28	1	33	76	44	46
138 875	35	1 1/4	36	82	50	53
141 745	42	1 1/2	38	96	56	60
222 017	54	2	28	65	67	78

SS = Spanner size
SS = spanner size

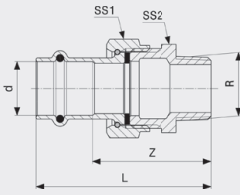

Sanpress Adapter union
- gunmetal
Model 2265

article	d	R	Z	L	SS1	SS2
291 372	12	3/8	37	55	30	27
291 389	12	1/2	40	58	30	27
120 108	15	1/2	43	65	30	27
140 878	15	3/4	44	66	30	28
283 360	18	1/2	45	67	30	27
283 377	18	3/4	47	69	30	28
142 674	22	1/2	46	69	37	34
119 133	22	3/4	50	74	37	34
148 492	22	1	51	75	37	34
365 110	28	3/4	55	79	46	44
120 047	28	1	54	78	46	44
128 425	35	1 1/4	63	88	53	50
135 966	42	1 1/2	65	101	60	55
221 997	54	2	67	107	78	70

SS = Spanner size
SS = spanner size

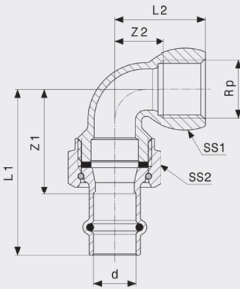

Sanpress Adapter union 90°
- gunmetal
Model 2255

article	d	Rp	Z1	Z2	L1	L2	SS1	SS2
292 980	12	1/2	36	18	53	28	28	30
125 660	15	1/2	38	18	60	33	28	30
283 469	18	1/2	40	18	62	33	28	30
283 452	18	3/4	42	23	64	39	33	36
122 614	22	3/4	47	23	70	39	33	37
132 637	22	1	50	25	74	44	40	37
128 159	28	1	57	28	81	47	40	46
132 729	35	1 1/4	60	35	85	56	47	53
139 872	42	1 1/2	72	38	108	59	55	60
221 676	54	2	74	43	114	68	69	78

SS = Spanner size
SS = spanner size

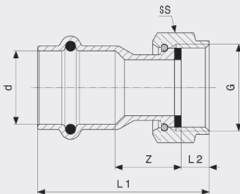

Sanpress Connection screw fitting
- gunmetal
Model 2263

article	VdS	d	G	Z	L1	L2	SS
475 956		12	3/8	17	41	6	22
380 878		12	1/2	13	30	7	24
293 611		12	3/4	10	27	9	30
476 786		14	3/8	18	44	6	22
443 849		14	1/2	15	40	6	24
444 150		14	3/4	12	39	8	30
475 963		15	3/8	19	41	7	22
380 885		15	1/2	15	37	6	24
265 663		15	3/4	12	34	8	30
305 000		15	1	11	33	8	36
424 534		15	1 1/4	14	36	12	50
444 167		16	1/2	16	41	6	24
444 174		16	3/4	12	39	8	30
283 391		18	3/4	14	36	8	30
305 017		18	1	11	33	8	36
351 502		22	3/4	20	44	8	30
265 687	✓	22	1	16	39	8	37
367 015	✓	22	1 1/4	13	36	10	50
305 260	✓	22	1 1/2	13	36	8	52
692 629		28	1	18	50	8	37
265 700	✓	28	1 1/4	18	42	10	46
305 048	✓	28	1 1/2	15	38	11	52
265 731	✓	35	1 1/2	18	44	10	53
305 024	✓	35	2	14	51	12	64
265 304	✓	42	1 3/4	22	58	10	60
305 031	✓	42	2	20	56	14	66
426 743	✓	54	2 1/4	22	62	14	72

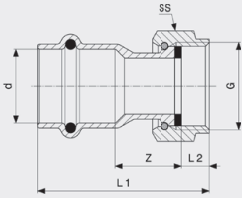

Sanpress Connection screw fitting
- gunmetal
Model 2263

article	VdS	d	G	Z	L1	L2	SS
265 328	✓	54	2 $\frac{3}{8}$	13	53	12	78
341 961	✓	54	2 $\frac{1}{2}$	16	56	16	84
426 750	✓	54	2 $\frac{3}{4}$	16	56	16	88

VdS = VdS certification
SS = wrench size

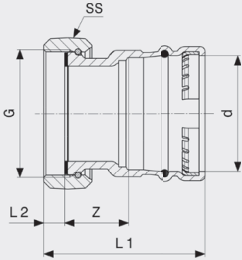

Sanpress XL Connection screw fitting
- gunmetal
Model 2263XL

article	d	G	Z	L1	L2	SS
365 127	76.1	3	42	111	14	96
365 134	88.9	3 $\frac{1}{2}$	42	111	14	110

SS = wrench size

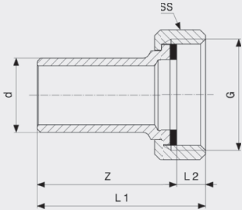

Sanpress Connection screw fitting
- gunmetal
Model 2264

article	d	G	Z	L1	L2	SS
338 503	15	$\frac{3}{4}$	41	48	8	29
338 510	18	$\frac{3}{4}$	41	48	8	29
338 527	22	1	42	50	8	36
338 534	28	1 $\frac{1}{4}$	44	54	10	46
338 541	35	1 $\frac{1}{2}$	46	56	10	52
338 558	42	1 $\frac{3}{4}$	63	74	12	58
338 565	54	2 $\frac{3}{8}$	57	68	11	74

SS = wrench size

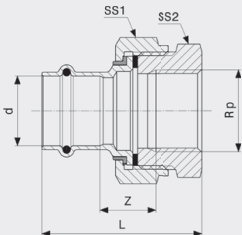

Sanpress Insulating union
- gunmetal
Model 2267

article	d	Rp	Z	L	SS1	SS2
469 450	15	$\frac{1}{2}$	18	54	37	34
469 467	15	$\frac{3}{4}$	25	64	37	34
469 474	18	$\frac{1}{2}$	20	58	46	44
469 481	18	$\frac{3}{4}$	19	58	46	44
469 498	22	$\frac{3}{4}$	21	63	55	50
469 504	22	1	23	65	55	50
469 511	28	1	23	65	55	50
469 528	35	1 $\frac{1}{4}$	21	68	70	62
469 535	42	1 $\frac{1}{2}$	19	77	73	68
469 542	54	2	24	90	88	83

SS = Spanner size
SS = spanner size

CAPS, PLUGS

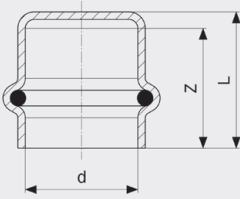

Profipress Cap
- copper
Model 2456

article	d	Z	L
349 295	12	20	23
444 075	14	21	24
349 301	15	23	26
444 082	16	20	23
349 363	18	23	27
349 356	22	24	27
349 349	28	26	29
349 332	35	30	34
349 325	42	37	41
349 318	54	42	46

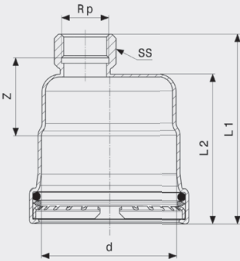

Profipress XL Cap
- copper
Model 2456XL

article	d	Rp	Z	L1	L2	SS
577 780	64.0	3/4	41	100	78	30
534 165	76.1	3/4	41	107	84	30
534 172	88.9	3/4	41	107	84	30
534 189	108.0	3/4	42	118	96	30

SS = wrench size

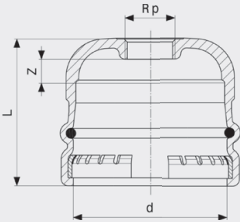

Sanpress XL Cap
- gunmetal
Model 2256XL

article	d	Rp	Z	L
353 377	76.1	3/4	12	76
353 384	88.9	3/4	11	77
353 391	108.0	3/4	15	89

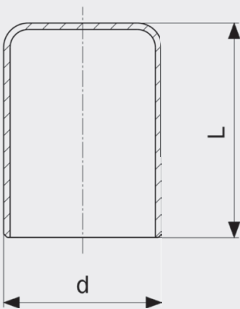

Profipress Plug
- copper
Model 2457

article	d	L
330 903	15	29
330 897	18	29
314 576	22	30
314 569	28	31
314 552	35	36
314 545	42	46
314 538	54	55

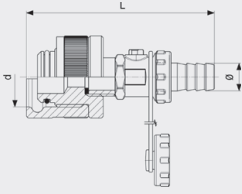

Forcing plug
- brass
Model 2269

article	d	L	Ø
290 801	12	117	14
141 523	15	120	14
289 423	18	120	14
140 557	22	119	14
142 568	28	131	14
144 111	35	119	14
144 999	42	123	14
187 798	54	127	14

Ø = diameter

FLANGES

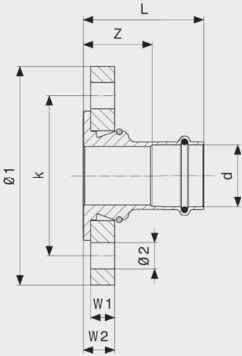

Sanpress Flange adapter
- gunmetal
Model 2259.5

article	DN	d	Z	L	W1	W2	Ø1	Ø2	k	n
479 855	25	28	42	65	16	21	115	14	85	4
479 879	32	35	44	70	16	21	140	18	100	4
479 886	40	42	47	83	16	21	150	18	110	4
479 893	50	54	50	90	16	21	165	18	125	4

Ø = diameter

k = bolt circle diameter

n = number of holes

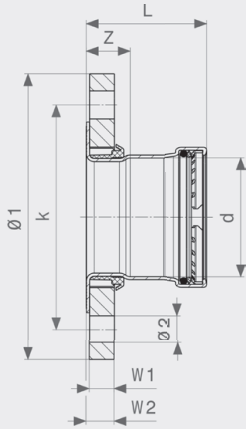

Profipress XL Flange adapter
- copper
Model 2459.5XL

article	DN	d	Z	L	W1	W2	Ø1	k	Ø2	n
577 797	65	64.0	28	72	16	18	185	145	18	8
648 534	65	66.7	28	71	16	18	185	145	18	8
534 042	65	76.1	28	78	16	18	185	145	18	8
534 059	80	88.9	30	80	18	20	200	160	18	8
534 066	100	108.0	32	92	18	20	220	180	18	8

Ø = diameter
k = bolt circle diameter
Ø = diameter
n = number of holes

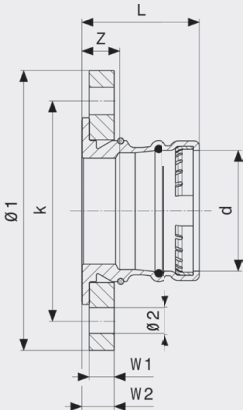

Sanpress XL Flange adapter
- gunmetal
Model 2259.5XL

article	DN	d	Z	L	W1	W2	Ø1	Ø2	k	n
479 954	65	76.1	25	78	16	21	185	18	145	8
479 978	80	88.9	27	80	18	23	200	18	160	8
480 011	100	108.0	17	80	18	23	220	18	180	8

Ø = diameter
k = bolt circle diameter
n = number of holes

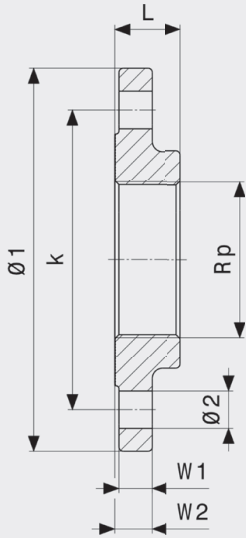

Sanpress XL Flange, PN 16
- gunmetal
Model 2259.2XL

article	DN	Rp	Ø1	L	W1	W2	Ø2	k	n
641 597	65	2½	185	32	16	18	18	145	8
641 603	80	3	200	34	18	20	18	160	8
641 610	100	4	220	38	18	20	18	180	8

Ø = diameter
k = bolt circle diameter
n = number of holes

WALL PLATES

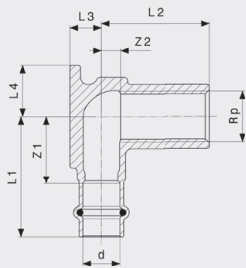

Sanpress Wall plate
- gunmetal
Model 2225

article	d	Rp	L	Z1	Z2	L1	L2	L3	L4
116 552	15	½	45	28	8	50	45	13	21

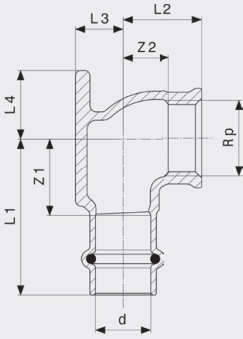

Sanpress Wall plate
- gunmetal
Model 2225.5

article	d	Rp	Z1	Z2	L1	L2	L3	L4	Z1*	Z2*	L1*	L2*	L3*	L4*
291 013	12	1/2	22	5	40	20	11	21						
444 044	14	1/2	25	12	44	22	13	21						
107 345	15	1/2	22	7	44	22	13	19	24	12	46	21	13	22
444 556	16	1/2	25	12	44	22	13	21						
281 502	18	1/2	22	7	44	22	14	19	24	12	46	21	15	22
335 236	18	3/4	28	13	50	24	16	21						
335 229	22	1/2	26	9	50	24	18	21						
116 057	22	3/4	26	11	50	27	18	21						

Z* = Z-dimension of the previous version
L* = length of the previous version

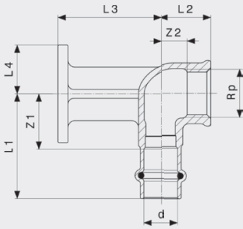

Sanpress Wall plate
- gunmetal
Model 2225.6

article	d	Rp	Z1	Z2	L1	L2	L3	L4
347 307	15	1/2	24	12	46	22	45	21

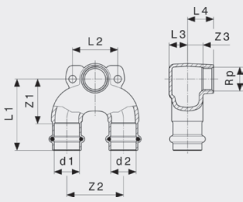

Sanpress Double wall plate
- gunmetal
Model 2228.7

article	d1	Rp	d2	Z1	Z2	Z3	L1	L2	L3	L4
687 892	15	1/2	15	34	50	8	56	40	13	23
692 797	18	1/2	18	34	50	8	56	40	14	23
687 908	22	1/2	22	40	50	8	63	40	16	23

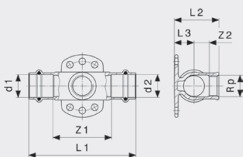

Sanpress Wall plate T-piece
- gunmetal
Model 2217.3

article	d1	Rp	d2	Z1	Z2	L1	L2	L3
644 864	15	1/2	15	48	8	92	36	13
625 726	22	1/2	22	57	28	104	43	19

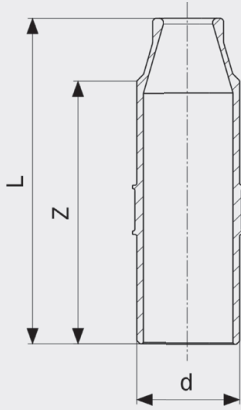

Press-in nozzle
- gunmetal
Model 2211.5

article	d	Z	L
695 835	22	56	69
695 842	28	58	74
696 252	35	62	77
696 269	42	82	100
696 276	54	90	113
696 283	64	102	122

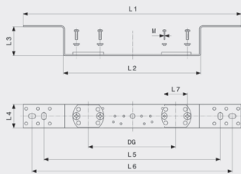

Mounting bracket
- galvanised steel
Model 2021.7

article	DG	L1	L2	L3	L4	L5	L6	L7	M
651 350	70/100/150	370	234	48	40	300	340	40	4

DG = depth gauge
M = thread type

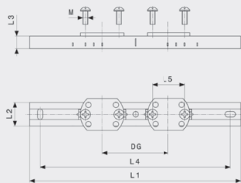

Mounting bracket
- galvanised steel
Model 2141.3

article	DG	L1	L2	L3	L4	L5	M
581 701	80-150	253	28	15	228	40	6

DG = depth gauge
M = thread type

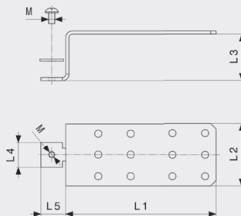

Mounting bracket
- galvanised steel
Model 2141.4

article	L1	L2	L3	L4	L5	M
586 706	140	58	43	24	23	6

M = thread type

**Sanpress Mounting unit
Model 2222.05**

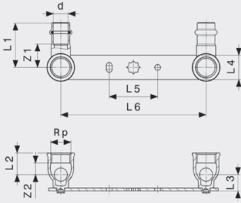

article	d	Rp	DG	Z1	Z2	L1	L2	L3	L4	L5	L6
308 681	15	1/2	150	24	12	46	22	17	25	50	150

DG = depth gauge

**Sanpress Mounting unit
Model 2222.2**

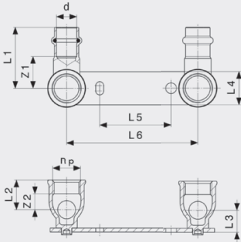

article	d	Rp	DG	Z1	Z2	L1	L2	L3	L4	L5	L6
308 674	15	1/2	100	24	12	46	22	17	25	55	100

DG = depth gauge

**Sanpress Mounting unit
Model 2218.4**

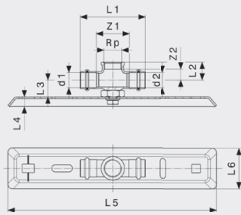

article	d1	Rp	d2	Z1	Z2	L1	L2	L3	L4	L5	L6
625 078	22	3/4	22	10	49	96	26	24	14	310	60

**Connection elbow 90°
Model 94477.0-713**

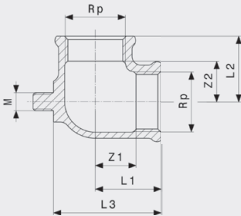

article	Rp	Z1	Z2	L1	L2	L3	M
374 570¹	1/2	10	10	25	25	40	8
489 298¹	3/4	13	13	29	29	47	8
138 066²	1	15	15	34	34	57	8

M = thread type

¹) gunmetal

²) brass

WALL LEAD-INS

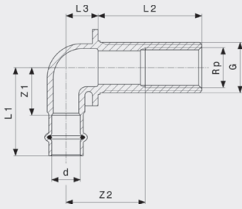

Sanpress Wall lead-in
- gunmetal
Model 2232.1

article	d	Rp	G	L	Z1	Z2	L1	L2	L3
279 301	15	1/2	3/4	25	25	27	47	24	18
279 318	15	1/2	3/4	35	25	22	47	34	18
279 288	15	1/2	3/4	55	25	42	47	54	18
279 295	15	1/2	3/4	65	25	52	47	64	18

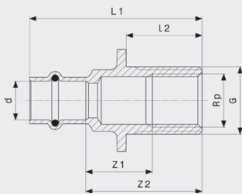

Sanpress Wall lead-in
- gunmetal
Model 2232.3

article	d	Rp	G	L	Z1	Z2	L1	L2
325 060	15	1/2	3/4	30	26	46	68	30

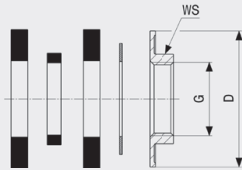

Mounting set
Model 1526.414-897

article	G	SS	D
104 887	3/4	29	49

SS = wrench size
D = external diameter

COMPENSATORS

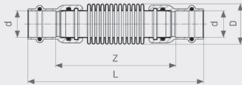

Compensator
Model 2251

article	d	Z	L	Ø
690 250	15	100	144	23
690 267	18	104	148	27
690 274	22	102	149	34
690 281	28	121	168	41
690 298	35	123	174	50
690 304	42	127	199	60
690 311	54	137	217	72

Ø = diameter

GUNMETAL BALL VALVES

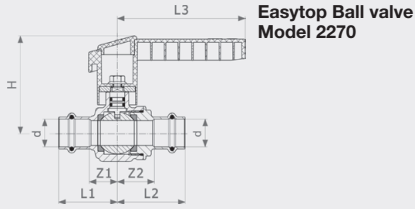

**Easytop Ball valve
Model 2270**

article	DN	d	Z1	Z2	L1	L2	L3	H1	H2
475 857 ¹	15	15	20	26	42	48	98	72	19
475 864 ¹	15	18	20	26	42	48	98	98	18
475 871 ¹	20	22	22	28	45	52	98	74	22
475 888 ¹	25	28	26	36	50	59	112	89	26
475 895 ¹	32	35	31	37	56	63	113	100	32
475 918 ¹	40	42	33	33	69	69	119	125	39
475 925 ¹	50	54	45	47	85	87	119	133	47

¹⁾ Discontinued, limited availability

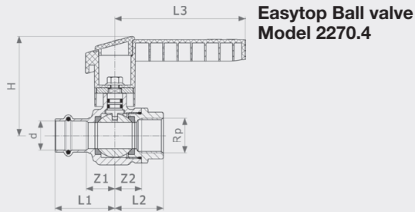

**Easytop Ball valve
Model 2270.4**

article	DN	d	Rp	Z1	Z2	L1	L2	L3	H1	H2
587 147 ¹	15	15	½	20	16	42	31	98	73	19
587 154 ¹	15	18	½	20	16	42	31	98	73	18
587 161 ¹	20	22	¾	21	20	45	37	98	73	22
587 178 ¹	25	28	1	26	24	50	43	112	89	26
587 185 ¹	32	35	1¼	31	29	56	51	113	100	32
587 192 ¹	40	42	1½	33	34	69	56	119	125	39
587 208 ¹	50	54	2	45	44	85	70	119	133	47

¹⁾ Discontinued, limited availability

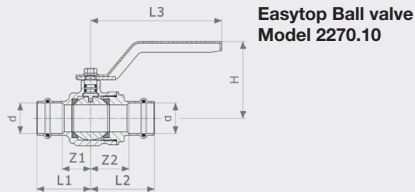

**Easytop Ball valve
Model 2270.10**

article	DN	d	Z1	Z2	L1	L2	L3	H1	H2
590 437	15	15	20	26	42	48	110	61	19
590 444	15	18	20	26	42	48	110	61	18
590 451	20	22	22	28	45	52	110	62	22
590 468	25	28	26	36	50	59	122	71	26
590 475	32	35	31	37	56	63	122	82	32
590 482	40	42	33	33	69	69	135	93	39
590 499	50	54	45	47	85	87	135	101	47

FREE-FLOW VALVES

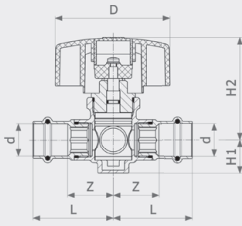

**Easytop Free-flow valve
Model 2242**

article	d	Z	L	H1	H2	Ø
606 312 ¹⁾	15	32	54	23	70	79
606 329 ¹⁾	18	31	53	23	70	79
606 336 ¹⁾	22	31	55	23	70	79

Ø = diameter

¹⁾ Discontinued, limited availability

CONCEALED FREE-FLOW VALVES, CONCEALED STRAIGHT SEAT VALVES

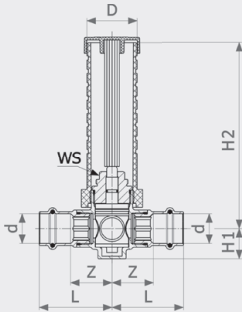

**Easytop Concealed free-flow valve
Model 2240**

article	d	ID	Z	L	H1	H2	ID	Ø1	Ø2
606 343 ¹⁾	15	45-130	32	54	12	23	132	38	44
606 459 ¹⁾	18	45-130	31	53	12	23	132	38	44
606 466 ¹⁾	22	45-130	31	55	12	23	132	38	44

ID = installation depth

Ø = diameter

¹⁾ Discontinued, limited availability

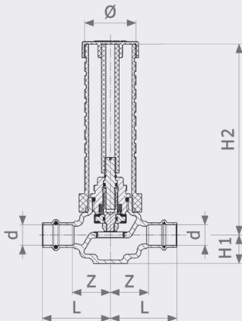

**Easytop Concealed straight seat valve
Model 2235**

article	DN	d	ID	Z	L	H1	H2	Ø
595 937 ¹⁾	15	15	45-130	28	50	21	141	38
595 944 ¹⁾	15	18	45-130	28	50	21	141	38
596 750 ¹⁾	20	22	45-130	26	50	21	141	38
596 767 ¹⁾	25	28	45-130	26	50	21	141	38

ID = installation depth

Ø = diameter

¹⁾ Discontinued, limited availability

MANIFOLDS, CROSS PIECES

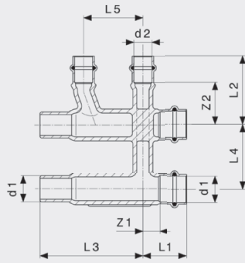

Sanpress Screed manifold
- gunmetal
Model 2252

article	d1	d2	d3	Z1	Z2	L1	L2	L3	L4	L5
364 298'	22	10	22	14	32	38	50	87	55	50
397 166	22	15	22	14	36	38	58	87	55	50

1) Press connection d10 should be carried out with a size 12 press jaw!

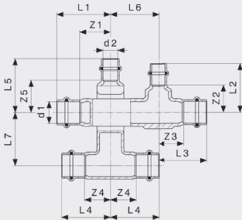

Sanpress Cross T-piece
- gunmetal
Model 2249.3

article	d1	d2	Z1	Z2	Z3	Z4	Z5	L1	L2	L3	L4	L5	L6	L7
493 325	15	15	33	28	28	28	33	55	50	50	50	55	50	55
493 332	18	15	33	28	28	28	33	55	50	50	50	55	50	55
493 356	22	15	32	28	26	26	33	55	50	50	50	55	50	55
493 349	22	18	32	28	26	26	33	55	50	50	50	55	50	55

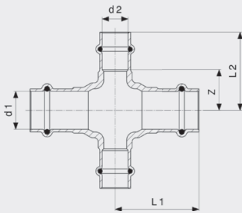

Sanpress Cross piece
- gunmetal
Model 2244

article	d1	d2	INDmin	Z	L1	L2
424 435	15	15	22	20	50	42
424 473	18	15	22	20	50	42
424 497	22	15	24	24	50	46

INDmin = insertion depth minimum

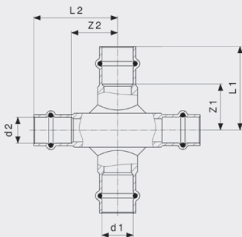

Sanpress Cross piece
- gunmetal
Model 2248

article	d1	d2	Z1	Z2	L1	L2
322 410	15	15	26	26	48	48
322 427	18	15	27	27	49	49
323 370	22	15	26	30	50	52
323 363	28	15	30	33	54	55

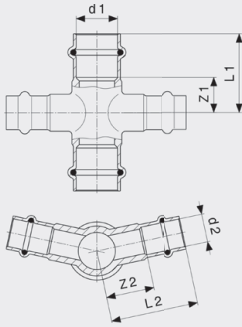

Sanpress Cross piece 24°
- gunmetal
Model 2247

article	d1	d2	Z1	Z2	L1	L2
325 985	18	15	20	24	42	46
325 978	22	15	19	20	42	48

RADIATOR CONNECTIONS

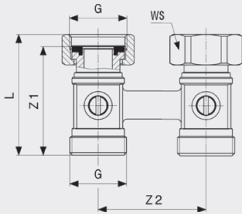

Radiator connection piece
- matt nickel-plated brass
Model 1096.5

article	G	DG	Z1	L	SS
359 102	3/4	50	48	54	30

DG = depth gauge
SS = wrench size

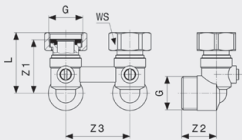

Radiator connection piece
- matt nickel-plated brass
Model 1097.5

article	G	DG	Z1	Z2	L	SS
359 133	3/4	50	42	27	47	30

DG = depth gauge
SS = wrench size

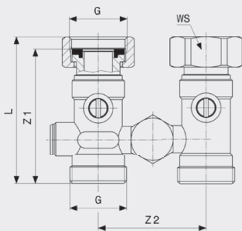

Radiator connection piece
- matt nickel-plated brass
Model 1096.0

article	G	DG	Z1	L	SS
359 096	3/4	50	62	68	30

DG = depth gauge
SS = wrench size

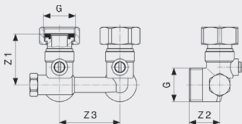

Radiator connection piece
- matt nickel-plated brass
Model 1097.0

article	G	DG	Z1	Z2	L	SS
359 126	3/4	50	43	26	47	30

DG = depth gauge
SS = wrench size

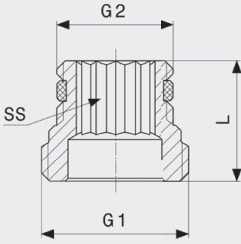

Adapter set
- brass
Model 1096.8

article	G1	G2	L	SS
357 122	1/2	3/4	22	12

SS = wrench size

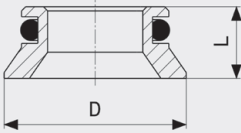

Adapter set
Model 1096.9

article	D	L
308 872	22	9

D = external diameter

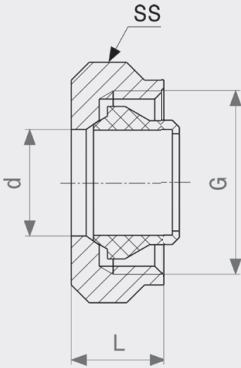

Connection screw fitting
- nickel-plated brass
Model 94385.1

article	d	G	L	SS
112 608	12	3/4	14	30
105 358	15	3/4	14	30

SS = wrench size

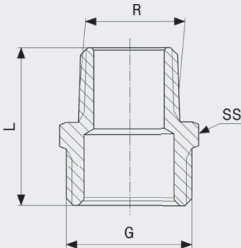

Adapter set
- matt nickel-plated brass
Model 1022.6

article	R	G	L	SS
153 687	1/2	3/4	33	27

SS = wrench size

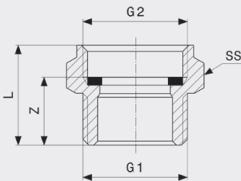

Adapter set
- matt nickel-plated brass
Model 1022.5

article	G1	G2	Z	L	SS
137 342	3/4	3/4	17	25	30

SS = wrench size

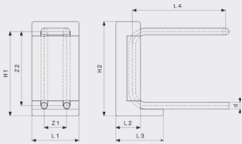

Radiator connection block
Model 1097.6

article	d	Z1	Z2	L1	L2	L3	L4	H1	H2
364 045	15	50	165	105	55	110	210	198	210
379 698	15	50	235	105	55	110	210	258	280

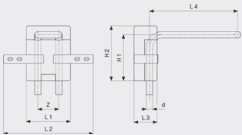

Radiator connection block
Model 1097.9

article	d	H	Z	L1	L2	L3	L4	H1	H2
586 379	15	150	50	105	214	55	210	109	130

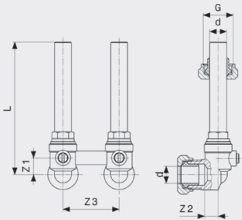

Radiator connection set
- matt nickel-plated brass
Model 1097.7

article	d	G	Z1	Z2	Z3	L
364 052	15	3/4	14	11	50	118

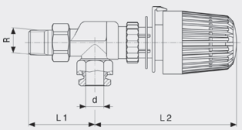

Radiator axial valve
- nickel-plated brass
Model 1075.96

article	d	R	L1	L2
360 405	15	1/2	56	120

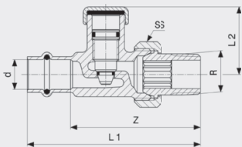

Sanpress Return pipe screw fitting
- gunmetal
Model 2272.2

article	d	R	Z	L1	L2	SS
326 364	15	1/2	67	89	34	29

SS = wrench size

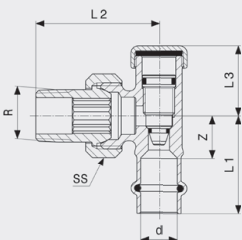

Sanpress Return pipe screw fitting
- gunmetal
Model 2272.1

article	d	R	Z	L1	L2	L3	SS
326 357	15	1/2	17	39	49	28	29

SS = wrench size

SKIRTING BOARD RADIATOR CONNECTION PIECES

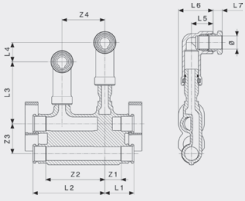

Skirting board radiator connection piece
- gunmetal
Model 2277.2

article	Ø	Z1	Z2	Z3	Z4	L1	L2	L3	L4	L5	L6	L7
662 509	15	19	69	35	50	34	84	72	22	25	40	11

Ø = diameter

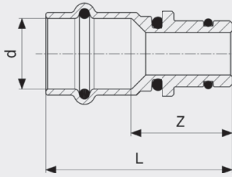

Sanpress Plug adapter
- gunmetal
Model 2233.5

article	d	Z	L
662 516	15	25	47
662 523	18	26	48
662 530	22	28	52

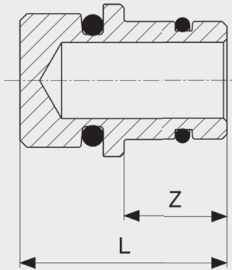

Plug adapter
- gunmetal
Model 2233.6

article	Z	L
663 346	15	30

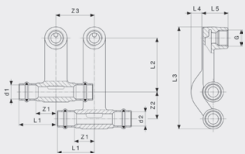

Sanpress Radiator connection piece
- gunmetal
Model 2273.1

article	d1	G	d2	Z1	Z2	Z3	L1	L2	L3	L4	L5
446 628	15	1/2	15	26	35	50	48	70	131	13	31
446 635	18	1/2	18	26	35	50	48	70	131	13	31

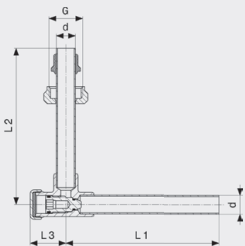

Radiator connection set
- nickel-plated brass
Model 2272.5

article	d	G	L1	L2	L3
360 399	15	3/4	120	120	28

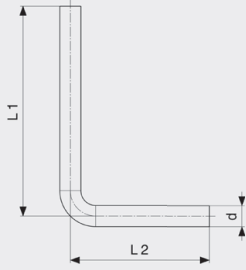

Connection elbow 90°
 - stainless steel
Model 2271.1

article	d	L1	L2
449 292	15	150	100
366 056	15	350	100

order code	page	order code	page	order code	page	order code	page	order code	page
104 306	13	142 568	27	291 310	16	296 407	21	315 054	7
104 887	33	142 674	24	291 341	16	296 414	21	315 061	7
105 044	13	144 111	27	291 372	24	296 421	21	315 078	7
105 358	38	144 999	27	291 389	24	296 438	21	315 085	7
106 508	13	148 492	24	291 488	4	296 445	21	317 423	15
107 345	30	153 687	38	291 495	4	296 452	21	317 430	15
107 543	14	187 279	8	291 501	4	296 469	21	317 447	15
108 441	18	187 798	27	291 518	4	296 476	21	317 454	15
108 465	14	194 123	10	291 525	4	296 483	21	317 508	15
110 352	13	194 130	10	291 532	4	296 490	21	322 328	7
112 608	38	194 147	10	291 549	4	296 506	21	322 335	7
112 950	17	195 267	13	291 556	4	297 930	13	322 342	7
114 329	14	195 304	14	291 648	4	297 947	13	322 359	7
115 340	13	197 353	11	291 655	4	297 954	13	322 410	36
115 418	16	197 858	10	291 662	4	297 961	13	322 427	36
115 623	17	197 988	17	291 679	4	297 978	13	322 687	8
115 630	11	199 104	16	291 686	4	297 985	13	322 694	7
115 944	11	216 153	20	291 693	4	298 050	14	322 700	7
116 057	30	221 676	24	291 709	4	298 067	14	322 717	7
116 552	29	221 997	24	291 716	4	298 074	14	322 724	7
116 767	16	222 017	23	291 884	7	298 081	14	323 363	36
116 774	14	226 329	23	291 891	7	298 098	14	323 370	36
117 481	16	265 304	24	291 907	7	298 104	14	323 707	22
117 733	16	265 328	25	291 914	7	298 111	14	323 714	22
118 730	17	265 663	24	291 921	7	298 128	14	323 721	22
119 041	20	265 687	24	291 938	7	298 227	18	324 827	7
119 133	24	265 700	24	291 945	7	298 234	18	324 834	7
119 485	20	265 731	24	291 952	7	298 241	18	324 841	8
119 676	16	273 231	10	291 969	8	298 586	21	324 858	8
119 768	11	279 288	33	291 976	8	298 876	15	324 865	8
120 047	24	279 295	33	291 983	8	298 883	15	324 872	8
120 108	24	279 301	33	291 990	8	298 913	14	324 889	8
120 917	16	279 318	33	292 003	8	299 415	18	324 896	8
121 945	11	281 205	17	292 010	7	299 422	18	324 902	8
122 034	16	281 236	18	292 027	7	303 815	16	324 919	8
122 133	20	281 328	10	292 034	8	303 822	16	324 926	8
122 614	24	281 359	11	292 041	8	304 744	16	324 933	8
122 942	16	281 502	30	292 058	8	305 000	24	325 060	33
124 236	14	283 230	13	292 065	8	305 017	24	325 770	22
124 311	23	283 360	24	292 072	8	305 024	24	325 787	22
124 335	20	283 377	24	292 348	5	305 031	24	325 794	22
125 288	16	283 384	23	292 355	5	305 048	24	325 800	22
125 318	23	283 391	24	292 362	5	305 260	24	325 817	22
125 660	24	283 452	24	292 379	5	307 899	8	325 978	37
126 124	23	283 469	24	292 386	5	308 001	18	325 985	37
126 148	23	283 483	14	292 393	5	308 674	32	326 357	39
126 230	11	283 490	13	292 409	5	308 681	32	326 364	39
127 329	17	283 551	8	292 416	5	308 872	38	328 252	22
128 159	24	283 704	18	292 508	6	310 929	10	328 269	22
128 425	24	283 711	18	292 515	6	310 936	10	328 276	22
128 500	17	283 728	18	292 522	6	313 951	11	330 897	26
128 975	23	285 081	16	292 539	6	313 968	11	330 903	26
130 589	16	285 104	16	292 546	6	313 975	11	331 528	16
130 947	23	287 009	14	292 553	6	314 132	8	335 021	14
130 954	16	287 016	14	292 560	6	314 163	8	335 229	30
131 494	20	287 061	20	292 577	6	314 224	8	335 236	30
131 937	23	287 085	16	292 676	19	314 354	17	335 281	17
132 231	16	287 108	16	292 683	19	314 361	17	335 946	20
132 446	23	287 436	23	292 690	19	314 378	18	338 503	25
132 637	24	287 764	13	292 706	19	314 385	18	338 510	25
132 729	24	287 771	13	292 713	19	314 538	26	338 527	25
133 160	23	288 068	15	292 720	19	314 545	26	338 534	25
133 900	23	289 423	27	292 737	19	314 552	26	338 541	25
134 730	16	290 764	13	292 744	19	314 569	26	338 558	25
135 430	16	290 771	13	292 980	24	314 576	26	338 565	25
135 966	24	290 801	27	293 017	23	314 651	13	341 961	25
137 342	38	290 863	17	293 024	23	314 668	13	347 307	30
138 066	32	290 870	17	293 611	24	314 910	23	349 295	26
138 875	23	290 924	18	294 519	14	314 958	15	349 301	26
139 872	24	290 931	18	295 189	8	315 009	7	349 318	26
140 557	27	290 986	11	295 196	8	315 016	8	349 325	26
140 878	24	291 013	30	296 377	21	315 023	8	349 332	26
141 523	27	291 068	14	296 384	21	315 030	8	349 349	26
141 745	23	291 075	14	296 391	21	315 047	7	349 356	26

order code	page	order code	page	order code	page	order code	page	order code	page
349 363	26	366 865	21	469 481	25	534 158	13	646 561	16
350 598	19	367 015	24	469 498	25	534 165	26	646 578	16
350 604	19	374 570	32	469 504	25	534 172	26	646 585	16
350 611	19	379 698	39	469 511	25	534 189	26	646 592	16
350 628	10	380 878	24	469 528	25	566 678	16	646 608	16
350 635	10	380 885	24	469 535	25	566 685	16	646 615	16
350 642	10	397 166	36	469 542	25	566 692	16	646 622	16
350 659	13	424 435	36	475 857	34	566 708	16	646 707	15
350 666	13	424 473	36	475 864	34	577 582	19	646 714	15
350 673	13	424 497	36	475 871	34	577 605	21	646 721	15
350 680	4	424 534	24	475 888	34	577 612	21	646 738	15
350 697	4	426 743	24	475 895	34	577 650	19	646 745	15
350 703	4	426 750	25	475 918	34	577 667	14	646 752	15
351 342	6	428 174	14	475 925	34	577 674	13	646 769	15
351 359	6	442 033	18	475 956	24	577 681	4	646 776	15
351 366	6	443 030	17	475 963	24	577 698	5	646 783	15
351 434	12	443 689	13	476 786	24	577 704	12	646 790	15
351 441	12	443 696	13	476 847	4	577 711	12	648 350	5
351 502	24	443 702	13	476 854	4	577 728	9	648 367	6
352 097	12	443 719	13	476 861	4	577 735	9	648 374	9
352 134	7	443 726	14	476 878	5	577 742	9	648 381	9
352 141	7	443 733	14	476 885	5	577 759	9	648 398	9
352 158	7	443 740	19	476 892	5	577 766	5	648 404	9
353 315	20	443 771	21	476 908	5	577 773	6	648 411	9
353 322	20	443 788	21	476 915	5	577 780	26	648 435	19
353 339	20	443 795	21	476 922	5	577 797	28	648 442	19
353 377	26	443 801	21	476 939	6	581 701	31	648 459	21
353 384	26	443 818	21	476 946	6	586 379	39	648 466	21
353 391	26	443 825	21	476 953	6	586 706	31	648 473	21
353 650	5	443 832	21	476 960	9	587 147	34	648 480	21
353 667	5	443 849	24	476 977	9	587 154	34	648 497	21
353 674	5	443 856	19	476 984	9	587 161	34	648 503	21
353 681	6	443 863	4	476 991	9	587 178	34	648 510	13
353 698	6	443 870	4	477 004	9	587 185	34	648 527	14
353 704	6	443 887	7	477 011	9	587 192	34	648 534	28
354 398	10	443 894	7	477 028	9	587 208	34	651 350	31
354 404	10	443 900	7	477 035	9	587 505	21	660 222	13
354 411	10	443 917	7	477 042	9	588 328	15	662 509	40
354 428	10	443 924	7	477 059	19	588 533	20	662 516	40
354 435	10	443 931	7	477 066	19	588 540	20	662 523	40
354 442	10	443 948	7	477 073	19	588 557	20	662 530	40
354 572	12	443 955	7	477 080	19	588 564	15	663 346	40
354 589	12	443 962	7	477 097	19	590 437	34	687 892	30
354 596	12	444 006	17	477 103	19	590 444	34	687 908	30
354 664	22	444 013	17	477 110	21	590 451	34	690 250	33
354 671	22	444 020	18	477 127	21	590 468	34	690 267	33
354 688	22	444 037	18	477 134	21	590 475	34	690 274	33
354 695	22	444 044	30	477 141	21	590 482	34	690 281	33
354 701	22	444 051	5	477 158	21	590 499	34	690 298	33
354 718	22	444 068	5	477 165	21	595 937	35	690 304	33
357 122	38	444 075	26	477 356	9	595 944	35	690 311	33
357 542	14	444 082	26	479 855	27	596 750	35	692 629	24
359 096	37	444 099	4	479 879	27	596 767	35	692 797	30
359 102	37	444 105	4	479 886	27	605 490	15	695 835	31
359 126	37	444 112	6	479 893	27	605 506	15	695 842	31
359 133	37	444 129	6	479 954	28	605 513	15	696 252	31
360 399	40	444 150	24	479 978	28	605 520	15	696 269	31
360 405	39	444 167	24	480 011	28	606 312	35	696 276	31
361 204	11	444 174	24	489 298	32	606 329	35	696 283	31
361 211	11	444 556	30	493 325	36	606 336	35	705 596	11
361 228	11	446 611	18	493 332	36	606 343	35	705 602	11
364 045	39	446 628	40	493 349	36	606 459	35	705 619	11
364 052	39	446 635	40	493 356	36	606 466	35	705 626	11
364 298	36	449 292	41	534 042	28	625 078	32	705 633	11
365 073	7	461 256	19	534 059	28	625 726	30	705 640	11
365 080	8	461 263	19	534 066	28	629 281	22	705 855	11
365 097	14	461 270	19	534 073	12	629 298	23	713 416	19
365 103	23	461 287	19	534 080	12	641 597	29	719 234	9
365 110	24	461 294	19	534 097	12	641 603	29	719 241	21
365 127	25	461 300	19	534 103	12	641 610	29		
365 134	25	461 317	19	534 110	12	644 864	30		
365 882	8	469 450	25	534 127	12	645 137	4		
366 056	41	469 467	25	534 134	13	645 144	5		
366 476	21	469 474	25	534 141	13	646 554	16		

order code	page	order code	page	order code	page	order code	page	order code	page

model no.	page	model no.	page	model no.	page	model no.	page	model no.	page
1022.5	38	2259.2XL	29						
1022.6	38	2259.5	27						
1075.12P	15	2259.5XL	28						
1075.96	39	2260	23						
1096.0	37	2262	23						
1096.5	37	2263	24						
1096.8	38	2263	25						
1096.9	38	2263XL	25						
1097.0	37	2264	25						
1097.5	37	2265	24						
1097.6	39	2267	25						
1097.7	39	2269	27						
1097.9	39	2270	34						
1526.414-897	33	2270.10	34						
2021.7	31	2270.4	34						
2113	16	2271.1	41						
2141.3	31	2272.1	39						
2141.4	31	2272.2	39						
2211	13	2272.5	40						
2211.1	16	2273.1	40						
2211.4	13	2277.2	40						
2211.5	31	2411XL	13						
2211XL	13	2412XL	14						
2212	14	2415	19						
2212.1	16	2415.1	21						
2212.3	14	2415.1XL	21						
2212.4	14	2415.2	22						
2213	15	2415.3	19						
2213P	15	2415.5XL	19						
2214	17	2415XL	19						
2214.1	17	2416	4						
2214.2	18	2416.1	4						
2214.3	18	2416.1XL	5						
2215.1	21	2416.2	22						
2215.1NC	22	2416XL	4						
2215.1XL	22	2417.2XL	12						
2215.4	20	2418	7						
2215.5	20	2418	8						
2215.5XL	20	2418.1	9						
2215.6	15	2418XL	9						
2215XL	19	2426	5						
2216.1XL	5	2426.1	6						
2216XL	4	2426.1XL	6						
2217.1	10	2426.2	23						
2217.2	11	2426XL	5						
2217.2XL	12	2427	7						
2217.3	30	2428	7						
2217.4	11	2456	26						
2218	8	2456XL	26						
2218.4	32	2457	26						
2218XL	10	2459.5XL	28						
2222.05	32	5313	16						
2222.2	32	5313P	15						
2225	29	94385.1	38						
2225.5	30	94477.0-713	32						
2225.6	30	9777.9	20						
2226.1XL	6								
2226XL	6								
2228.7	30								
2232.1	33								
2232.3	33								
2233.5	40								
2233.6	40								
2235	35								
2240	35								
2242	35								
2244	36								
2247	37								
2248	36								
2249.3	36								
2251	33								
2252	36								
2255	24								
2256XL	26								