

Sanpress Inox with SC-Contur

Piping technology
stainless steel

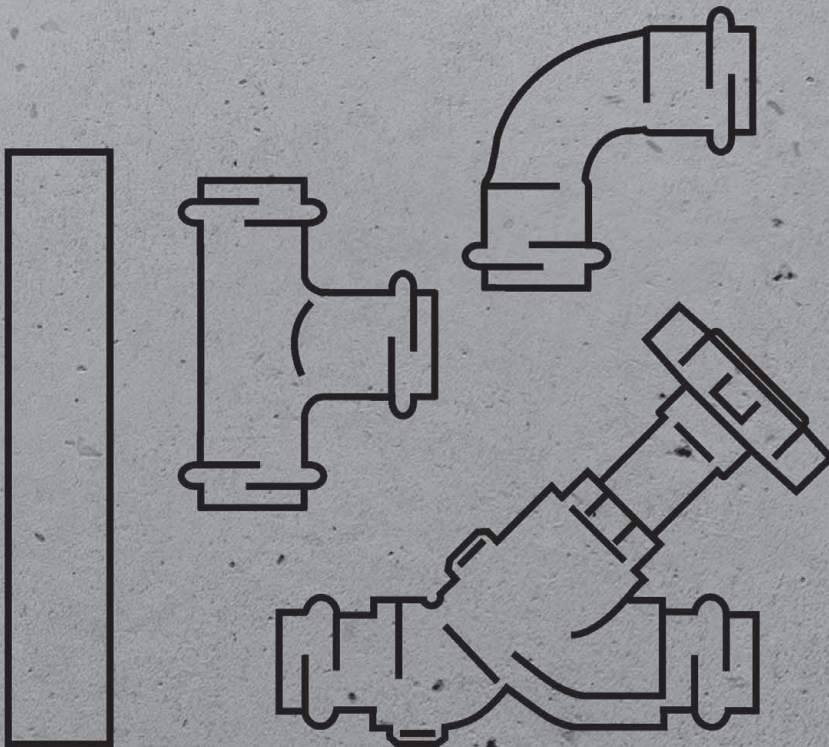

Press connector system with press connectors and pipes made of stainless steel material Nos. 1.4401 and 1.4521 in acc. with DIN EN 10088, DIN EN 10312, DVGW worksheet GW 541, system certification for connectors and pipes in acc. with DVGW worksheet W 534, for drinking water installations in acc. with DIN 1988. For dimensionally stable concealed and pre-wall installations of manifold and riser pipes in Viega component assembly.

Press connectors

All sizes with SC-Contur – connections, which remain unpressed become visible when the system is filled. The SC-Contur is certified and fulfils the requirements of DVGW worksheet W 534, point 12.14, connectors with forced leakage. During leakage tests with water, Viega guarantees the identification of unpressed connections in the pressure range 0.1 MPa–0.65 MPa, in the case of a dry leakage test with compressed air or noble gases from 22 hPa–0.3 MPa.

Marking

Green dot on the press connection

Sealing elements

EPDM, black (ethylene-propylene-dien-monomer rubber); up to 110 °C; not resistant against hydrocarbon solvent, chlorinated hydrocarbon solvents, turpentine, petrol

Pipes

Stainless steel laser-welded and made of corrosion-proof stainless steel

- Material-No.1.4401 (AISI 316L) (X5CrNiMo 17-12-2), with 2.3 % molybdenum for increased durability; yellow plugs
- Material-No.1.4521 (AISI 444) (X2CrMoTi 18-2), with PRE-value 24.1; green plugs

Dimensions/Material

Standard sizes: d 15; 18; 22; 28; 35; 42; 54 made of stainless steel

XL sizes: d 64.0; 76.1; 88.9; 108.0 made of stainless steel

Press connectors with threaded connection made of stainless steel

Areas of application

Drinking water
Heating/Radiator connection
Rainwater
Compressed air system
Agriculture
Industry

Special applications

Shipbuilding
Fire extinguisher systems

Use of the system for application areas and media other than those described here must be agreed with Viega Service Center.

Operating conditions

Drinking water installations

- Drinking water without restrictions in acc. with DWO
- Operating temperature max. 85 °C
- Operating pressure max. 1.6 MPa

Heating installations

- Operating temperature max. 110 °C
- Operating pressure max. 1.6 MPa

Irrelevant of the direction of flow, mixed installations are permitted.

Note

The system components should be protected against high concentrations of chloride generated by both the medium and by external factors.

Note - Limitations of use heating systems

Observe VDI 2035 and DINEN 12828!

Certification

Pipe 1.4521 (d 12–108.0)

- DW-7301BS0375

Pipe 1.4401 (d 12–108.0)

- DV-7301BS0411

System with pipe 1.4401 (d 15–108.0)

- DW 8501BL0551

System with pipe 1.4521 (d 15–108.0)

- DW 8501BS0376

Use of press tools

The functional safety of the Viega press connector systems is primarily dependent on the perfect condition of the press tools and press machines used. For this reason, for the production of press connections, we recommend the use of Viega press tools and their regular inspection by authorised service points.

Technical data

Press connectors and components are constantly being optimised. If required, the current Z and installation dimensions can be obtained from the download area of the Viega homepage: www.viega.com

INDEX

Elbows	4
T-pieces	6
Adapter pieces/adapter elbows	9
Couplings	13
Reductions	14
Screw fittings	14
Caps, plugs	16
Flanges	17
Wall plates	18
Compensators	19
Stainless steel shut-off valves	20
Stainless steel ball valves	21
Free-flow and straight seat valves	21



GTIN-Code (Global Trade Item Number, previously EAN-Code)

The GTIN-Code composed out of the constant manufacturer number 4015211 and a six-digit article code - in this example 305 611. The exchange of the last six digits against the article code shows the GTIN-Code.

ELBOWS

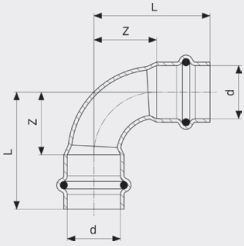

Sanpress Inox Elbow 90°
- steel non-corroding
Model 2316

article	d	Z	L	Z*	L*
435 639	15	16	40	26	48
435 646	18	18	40	36	58
435 653	22	26	49	44	67
435 660	28	34	58	48	72
435 677	35	33	59	60	86
435 684	42	50	87	71	107
435 691	54	65	105	92	132

Z* = previous version
L* = length of the previous version

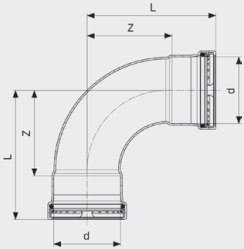

Sanpress Inox XL Elbow 90°
- steel non-corroding
Model 2316XL

article	d	Z	L
577 988	64.0	84	126
482 596	76.1	99	149
482 602	88.9	114	164
482 619	108.0	138	198

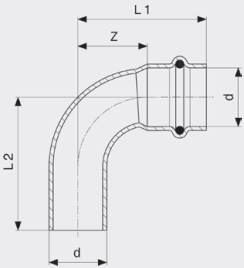

Sanpress Inox Elbow 90°
- steel non-corroding
Model 2316.1

article	d	Z	L1	L2	Z*	L1*	L2*
435 707	15	16	38	40	26	48	53
435 714	18	18	40	41	30	52	63
435 721	22	26	49	50	37	60	77
435 738	28	34	58	59	48	72	82
435 745	35	33	59	62	60	86	96
435 752	42	50	87	88	71	107	117
435 769	54	65	105	107	92	132	142

Z* = previous version
L* = length of the previous version

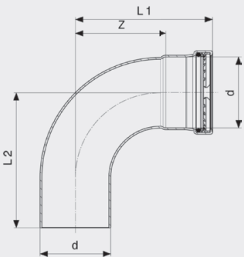

Sanpress Inox XL Elbow 90°
- steel non-corroding
Model 2316.1XL

article	d	Z	L1	L2
577 995	64.0	84	126	126
482 626	76.1	99	149	146
482 633	88.9	114	164	162
482 640	108.0	138	198	195

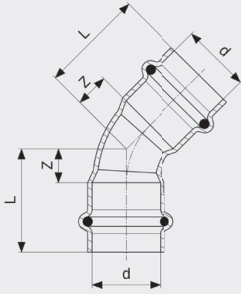

Sanpress Inox Elbow 45°
- steel non-corroding
Model 2326

article	d	Z	L	Z*	L*
435 776	15	7	29	13	35
435 783	18	7	29	18	40
435 790	22	11	34	22	45
435 806	28	14	38	21	45
435 813	35	15	41	28	54
435 363	42	21	57	33	69
435 370	54	27	67	44	84

Z* = previous version
L* = length of the previous version

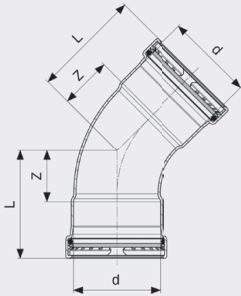

Sanpress Inox XL Elbow 45°
- steel non-corroding
Model 2326XL

article	d	Z	L
578 008	64.0	39	82
482 657	76.1	46	96
482 664	88.9	52	102
482 671	108.0	61	121

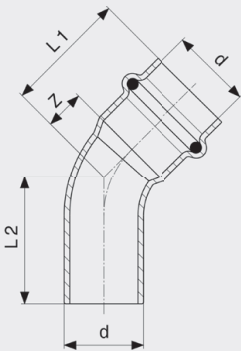

Sanpress Inox Elbow 45°
- steel non-corroding
Model 2326.1

article	d	Z	L1	L2	Z*	L1*	L2*
435 387	15	7	29	29	13	35	39
435 394	18	7	29	30	15	37	47
435 400	22	11	34	35	17	40	58
435 417	28	14	38	39	21	45	55
435 424	35	15	41	42	28	54	64
435 431	42	21	57	59	33	69	79
435 448	54	27	67	69	44	84	94

Z* = previous version
L* = length of the previous version

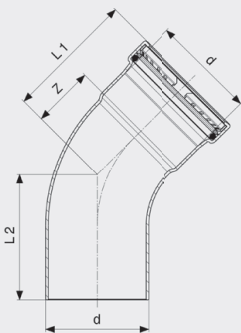

Sanpress Inox XL Elbow 45°
- steel non-corroding
Model 2326.1XL

article	d	Z	L1	L2
578 015	64.0	39	82	82
482 688	76.1	46	96	93
482 695	88.9	52	102	99
482 701	108.0	61	121	119

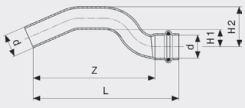

Sanpress Inox Crossover
- steel non-corroding
Model 2327

article	VdS	d	Z	L	H1	H2
452 926		15	97	119	12	28
452 933		18	103	125	13	31
452 940	✓	22	123	146	15	37

VdS = VdS certification

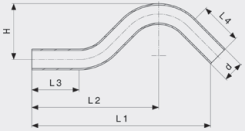

Sanpress Crossover
- steel non-corroding
Model 2209.3

article	d	L1	L2	L3	L4	H
193 324	15	153	39	39	10	48
289 010	18	175	45	45	17	52
193 331	22	182	50	45	27	59
193 294	28	205	60	50	42	67

T-PIECES

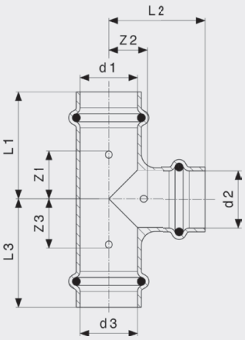

Sanpress Inox T-piece
- steel non-corroding
Model 2318

article	d1	d2	d3	Z1	Z2	Z3	L1	L2	L3
435 851	15	15	15	19	22	19	41	44	41
452 469	18	15	15	32	22	19	54	44	41
435 929	18	15	18	21	23	21	43	45	43
435 868	18	18	18	21	23	21	43	45	43
435 936	22	15	22	22	25	22	45	47	45
435 943	22	18	22	22	25	22	45	47	45
435 875	22	22	22	24	26	24	47	50	47
435 950	28	15	28	21	29	21	45	51	45
435 967	28	18	28	21	29	21	45	51	45
452 506	28	22	22	23	30	41	47	54	64
435 974	28	22	28	23	30	23	47	54	47
435 882	28	28	28	28	29	28	52	53	52
435 981	35	15	35	19	32	19	45	54	45
435 998	35	18	35	19	32	19	45	54	45
436 001	35	22	35	21	34	21	47	57	47
436 018	35	28	35	26	33	26	53	57	53
435 899	35	35	35	26	26	26	53	53	53
436 025	42	18	42	19	36	19	55	58	55
436 032	42	22	42	19	38	19	55	60	55
436 049	42	28	42	25	36	25	61	60	61
435 837	42	35	42	25	30	25	61	56	61
435 905	42	42	42	32	32	32	68	68	68
435 844	54	22	54	18	44	18	58	66	58
436 056	54	28	54	21	42	21	61	66	61
436 063	54	35	54	25	36	25	65	62	65
436 070	54	42	54	29	38	29	69	74	69
435 912	54	54	54	39	39	39	79	79	79

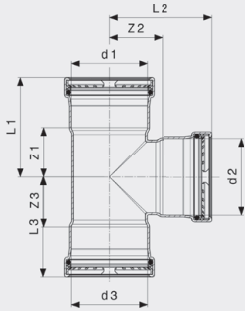

Sanpress Inox XL T-piece
- steel non-corroding
Model 2318XL

article	d1	d2	d3	Z1	Z2	Z3	L1	L2	L3
578 077	64.0	22	64.0	25	41	25	68	64	68
578 060	64.0	28	64.0	27	41	27	70	65	70
578 053	64.0	35	64.0	32	42	32	74	68	74
578 046	64.0	42	64.0	35	44	35	78	80	78
578 039	64.0	54	64.0	41	44	41	84	84	84
578 022	64.0	64.0	64.0	46	48	46	89	90	89
483 005	76.1	22	76.1	24	47	24	74	70	74
483 012	76.1	28	76.1	26	47	26	76	71	76
483 029	76.1	35	76.1	30	48	30	80	74	80
483 036	76.1	42	76.1	34	50	34	84	86	84
482 725	76.1	54	76.1	40	51	40	90	91	90
593 360	76.1	64.0	76.1	50	54	50	100	97	100
482 718	76.1	76.1	76.1	50	54	50	100	104	100
483 043	88.9	22	88.9	24	54	24	74	77	74
483 050	88.9	28	88.9	26	54	26	76	78	76
483 067	88.9	35	88.9	30	54	30	80	81	80
483 074	88.9	42	88.9	34	56	34	84	92	84
482 749	88.9	54	88.9	40	56	40	90	97	90
593 377	88.9	64.0	88.9	50	61	50	100	104	100
482 756	88.9	76.1	88.9	50	60	50	100	110	100
482 732	88.9	88.9	88.9	57	61	57	107	111	107
483 081	108.0	22	108.0	24	63	24	84	86	84
483 098	108.0	28	108.0	26	63	26	86	87	86
483 104	108.0	35	108.0	30	64	30	90	90	90
483 111	108.0	42	108.0	34	66	34	94	102	94
482 770	108.0	54	108.0	40	67	40	100	107	100
593 384	108.0	64.0	108.0	50	70	50	110	113	110
482 787	108.0	76.1	108.0	50	70	50	110	120	110
482 794	108.0	88.9	108.0	57	70	57	117	120	117
482 763	108.0	108.0	108.0	66	70	66	126	130	126

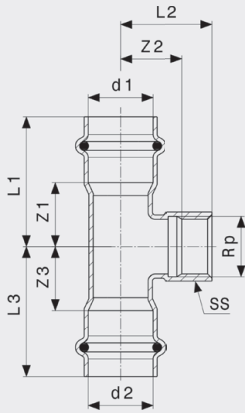

Sanpress Inox T-piece
- steel non-corroding
Model 2317.2

article	d1	Rp	d2	Z1	Z2	Z3	L1	L2	L3	SS
437 145	15	1/2	15	19	14	19	41	29	41	24
437 152	18	1/2	18	21	15	21	43	30	43	24
437 169	18	3/4	18	24	18	24	46	34	46	30
437 176	22	1/2	22	22	17	22	45	32	45	24
437 183	22	3/4	22	24	17	24	47	33	47	30
437 190	28	1/2	28	21	21	21	45	36	45	24
437 206	28	3/4	28	23	21	23	47	37	47	30
449 506	28	1	28	28	21	28	52	40	52	36
437 213	35	1/2	35	19	24	19	45	40	45	24
437 220	42	1/2	42	19	28	19	55	43	55	24
437 237	54	1/2	54	18	34	18	58	49	58	24

SS = wrench size

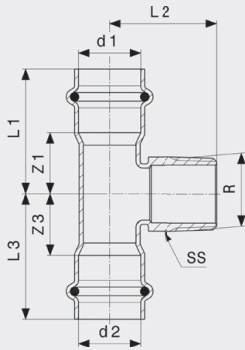

Sanpress Inox T-piece
- steel non-corroding
Model 2317.1

article	d1	R	d2	Z1	Z3	L1	L2	L3	SS
445 973*	18	3/4	18	21	21	43	38	43	27
445 980	22	3/4	22	22	22	45	39	45	27
445 997	28	3/4	28	21	21	45	43	45	27
446 000	35	3/4	35	21	21	47	46	47	27
446 017	42	3/4	42	19	19	55	50	55	27
446 024	54	3/4	54	18	18	58	56	58	27
446 031	54	1	54	21	21	61	60	61	36

SS = wrench size

* = Discontinued, limited availability

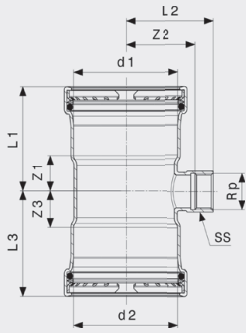

Sanpress Inox XL T-piece
- steel non-corroding
Model 2317.2XL

article	d1	Rp	d2	Z1	Z2	Z3	L1	L2	L3	SS
578 145	64.0	¾	64.0	25	40	25	68	56	68	30
578 152	64.0	2	64.0	41	42	41	84	67	84	65
482 862	76.1	¾	76.1	24	46	24	74	62	74	30
482 879	76.1	2	76.1	40	48	40	90	74	90	65
482 886	88.9	¾	88.9	24	52	24	74	68	74	30
482 893	88.9	2	88.9	40	54	40	90	80	90	65
482 909	108.0	¾	108.0	24	62	24	84	78	84	30
482 916	108.0	2	108.0	40	72	40	100	90	100	65

SS = wrench size

ADAPTER PIECES/ADAPTER ELBOWS

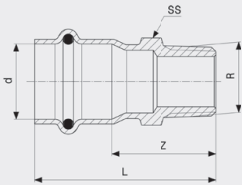

Sanpress Inox Adapter
- steel non-corroding
Model 2311

article	d	R	Z	L	SS
436 445	15	½	31	53	22
436 452	15	¾	34	56	27
436 469	18	½	30	52	22
436 476	18	¾	33	55	27
436 483	22	½	31	54	24
436 490	22	¾	33	56	27
436 506	22	1	37	60	36
436 513	28	¾	32	56	30
436 520	28	1	36	60	36
436 537	35	1	38	64	36
436 544	35	1¼	43	69	46
436 551	42	1½	45	81	50
436 568	54	2	51	90	63

SS = wrench size

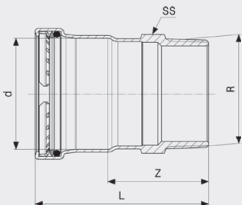

Sanpress Inox XL Adapter
- steel non-corroding
Model 2311XL

article	d	R	Z	L	SS
619 985	64.0	2½	66	109	80
482 923	76.1	2½	64	114	80
483 128	88.9	3	68	118	90
482 930	108.0	4	74	134	114

SS = wrench size

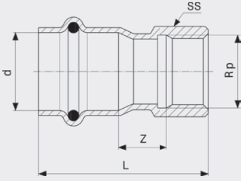

Sanpress Inox Adapter
- steel non-corroding
Model 2312

article	d	Rp	Z	L	SS
436 575	15	1/2	12	49	24
436 582	15	3/4	11	50	30
436 599	18	1/2	11	48	24
436 605	18	3/4	11	49	30
436 612	22	1/2	11	49	24
436 629	22	3/4	11	50	30
436 636	22	1	11	53	36
436 643	28	3/4	11	51	30
436 650	28	1	11	54	36
436 667	35	1 1/4	12	60	46
436 674	42	1 1/2	15	72	55
436 681	54	2	17	82	65

SS = wrench size

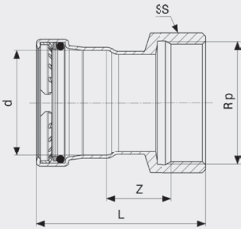

Sanpress Inox XL Adapter
- steel non-corroding
Model 2312XL

article	d	Rp	Z	L	SS
619 954	64.0	2 1/2	24	98	82
619 961	76.1	2 1/2	24	104	82
619 978	88.9	3	30	114	100

SS = wrench size

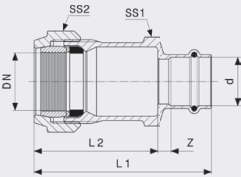

Sanpress Adapter
- gunmetal
Model 2215.6

article	DN	d	Z	L1	L2	SS1	SS2
588 564	25	28	8	104	72	50	55
588 328	32	35	8	112	78	68	70

SS = Spanner size
SS = spanner size

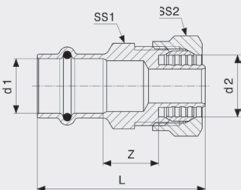

Sanpress Adapter
- gunmetal
Model 2213

article	d1	d2	L	Z	SS1	SS2
288 068	15	16	54	16	24	26
298 876*	15	20	58	20	27	30
298 883*	18	20	56	18	27	30

SS = Spanner size
SS = spanner size
* = Discontinued, limited availability

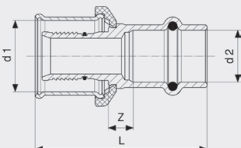

Sanfix P Adapter
- gunmetal
Model 2213P

article	d1	d2	L	Z
317 423	16	15	48	6
317 447	16	18	51	9
317 430	20	15	51	7
317 454	20	18	52	8
317 508	20	22	54	9
605 490	25	22	56	8
605 506	32	28	61	9
605 513*	40	28	64	10
605 520	40	35	65	10

* = Discontinued, limited availability

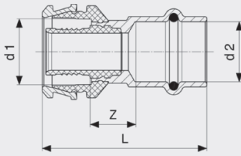

Raxofix Adapter
- gunmetal
Model 5313P

article	d1	d2	Z	L
646 707	16	15	13	50
646 714	16	18	14	51
646 721	20	15	13	50
646 738	20	18	14	50
646 745	20	22	15	53
646 752	25	22	16	59
646 769	32	28	15	58
646 776	40	28	21	71
646 783	40	35	19	70
646 790	50	35	24	76

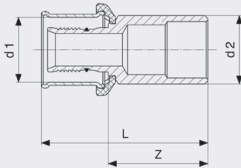

Sanfix P Plug-in piece
- gunmetal
Model 2113

article	d1	d2	Z	L
303 822	16	15	33	52
303 815	16	18	31	51
331 528	20	18	30	51
304 744	20	22	33	54
566 678	25	22	33	57
566 685	32	28	36	64
566 692	40	35	40	69
566 708	50	42	51	86

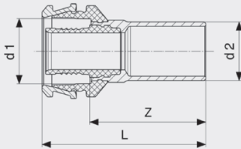

Raxofix Plug-in piece
- gunmetal
Model 5313

article	d1	d2	Z	L
646 554	16	15	36	51
646 561	16	18	37	52
646 578	20	18	36	50
646 585	20	22	39	54
646 592	25	22	40	60
646 608	32	28	41	61
646 615	40	35	47	74
646 622	50	42	62	88

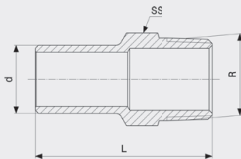

Sanpress Inox Plug-in piece
- steel non-corroding
Model 2311.1

article	d	R	L	SS
436 704	15	1/2	51	22
436 711	18	1/2	50	22
436 728	18	3/4	52	28
436 735	22	1/2	49	22
436 742	22	3/4	52	28
436 759	28	1	56	35
436 766	35	1 1/4	64	43
436 773	42	1 1/2	75	50
436 780	54	2	86	62

SS = wrench size

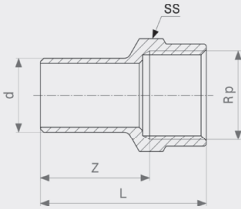

Sanpress Inox Plug-in piece
- steel non-corroding
Model 2312.1

article	d	Rp	Z	L	SS
436 797	15	1/2	32	47	26
436 803	18	1/2	31	46	26
436 810	18	3/4	34	50	30
436 827	22	1/2	31	46	26
436 834	22	3/4	33	50	30
436 841	28	3/4	30	46	30
436 858	28	1	34	53	38
436 865	35	1 1/4	37	58	47
436 872	42	1 1/2	51	72	53
436 889	54	2	54	80	70

SS = wrench size

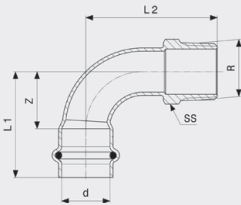

Sanpress Inox Adapter elbow 90°
- steel non-corroding
Model 2314

article	d	R	Z	L1	L2	SS	Z*	L1*	L2*	SS*
436 896	15	1/2	16	38	44	22	26	38	40	22
436 902	18	1/2	18	40	46	22	30	52	43	22
436 919	18	3/4	18	40	46	27	30	52	52	27
436 926	22	3/4	26	49	61	27	37	60	61	27
436 933	28	1	34	58	76	36				
436 940	35	1 1/4	32	68	78	46	60	86	91	45
436 957	42	1 1/2	50	87	102	50				
436 964	54	2	65	105	123	63				

SS = wrench size

Z* = previous version

L* = length of the previous version

SS* = previous version (spanner size)

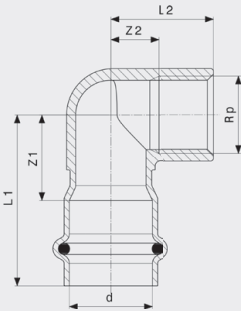

Sanpress Inox Adapter elbow 90°
- steel non-corroding
Model 2314.2

article	d	Rp	Z1	Z2	L1	L2
436 971	15	1/2	24	11	46	26
436 988	15	3/4	26	11	48	28
436 995	18	1/2	23	11	45	26
437 008	18	3/4	25	11	47	28
437 015	22	1/2	23	13	46	28
437 022	22	3/4	26	13	49	30
437 039	22	1	31	13	54	32
437 046	28	1	30	16	54	36
437 053	35	1 1/4	26	20	62	42
437 060	42	1 1/2	40	24	76	45
437 077	54	2	49	29	89	55

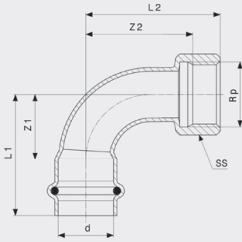

Sanpress Inox Adapter elbow 90°
- steel non-corroding
Model 2314.5

article	d	Rp	Z1	Z2	L1	L2	SS	Z1*	Z2*	L1*	L2*	SS*
437 091	15	½	16	24	39	36	24	26	21	38	44	24
437 107	18	¾	18	27	40	40	30	30	24	52	40	30
437 114	22	¾	26	39	49	55	30	37	44	60	55	30
437 121	28	1	34	51	58	70	36					
437 138	35	1¼	32	47	59	68	46	60	64	86	83	46

SS = wrench size

Z* = Z-dimension of the previous version

L* = length of the previous version

SS* = previous version (spanner size)

COUPLINGS

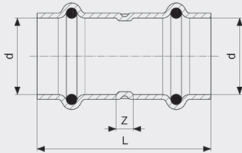

Sanpress Inox Coupling
- steel non-corroding
Model 2315

article	d	Z	L
436 155	15	12	56
436 162	18	11	55
436 179	22	12	58
436 186	28	12	60
436 193	35	12	64
436 209	42	12	84
436 216	54	12	92

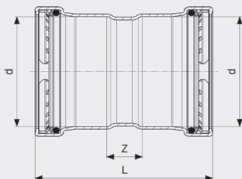

Sanpress Inox XL Coupling
- steel non-corroding
Model 2315XL

article	d	Z	L
578 084	64.0	24	110
482 800	76.1	25	125
482 817	88.9	25	125
482 824	108.0	25	145

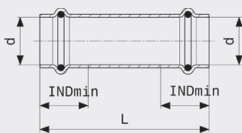

Sanpress Inox Sliding coupling
- steel non-corroding
Model 2315.5

article	d	L	INDmin
436 377	15	80	22
436 384	18	80	22
436 391	22	80	23
436 407	28	96	24
436 414	35	106	26
436 421	42	120	36
436 438	54	136	40

INDmin = insertion depth minimum

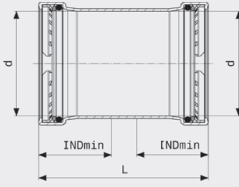

Sanpress Inox XL Sliding coupling
- steel non-corroding
Model 2315.5XL

article	d	L	INDmin
578 091	64.0	110	43
482 831	76.1	125	50
482 848	88.9	125	50
482 855	108.0	145	60

INDmin = insertion depth minimum

REDUCTIONS

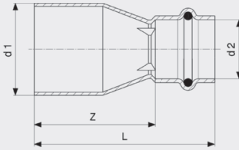

Sanpress Inox Reducer
- steel non-corroding
Model 2315.1

article	d1	d2	Z	L
436 223	18	15	30	52
436 230	22	15	35	57
436 247	22	18	37	59
436 254	28	15	50	72
436 261	28	18	47	69
436 278	28	22	42	64
436 285	35	18	50	72
436 292	35	22	51	74
436 308	35	28	43	67
436 315	42	22	65	88
436 322	42	28	64	88
436 339	42	35	54	80
436 346	54	28	75	99
436 353	54	35	71	97
436 360	54	42	65	101

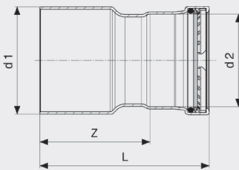

Sanpress Inox XL Reducer
- steel non-corroding
Model 2315.1XL

article	d1	d2	Z	L
578 107	64.0	54	71	111
483 135	76.1	54	84	124
578 114	76.1	64.0	83	126
483 142	88.9	54	90	130
578 121	88.9	64.0	89	132
483 159	88.9	76.1	81	131
483 166	108.0	54	109	149
578 138	108.0	64.0	108	151
483 173	108.0	76.1	102	152
483 180	108.0	88.9	94	144

SCREW FITTINGS

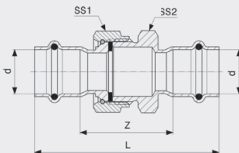

Sanpress Inox Screw fitting
- steel non-corroding
Model 2360

article	VdS	d	Z	L	SS1	SS2
437 381		15	42	86	30	30
437 398		18	41	85	27	30
437 404	✓	22	48	94	36	37
437 411	✓	28	52	100	46	46
437 428	✓	35	58	111	50	53
437 435	✓	42	67	139	55	60
437 442	✓	54	70	150	70	78

VdS = VdS certification

SS = Spanner size

SS = spanner size

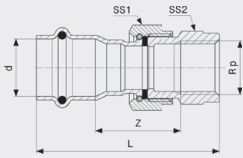

Sanpress Inox Adapter union
- steel non-corroding
Model 2362

article	d	Rp	Z	L	SS1	SS2
437 459	15	1/2	29	66	30	27
437 466	15	3/4	33	71	30	30
437 473	18	1/2	28	65	30	27
437 480	18	3/4	32	71	30	30
437 497	22	1/2	34	72	30	27
437 503	22	3/4	40	79	30	30
437 510	22	1	39	81	40	37
437 527	28	3/4	46	86	37	34
437 534	28	1	47	90	37	40
437 541	35	1 1/4	36	83	53	50
437 558	42	1 1/2	41	98	60	55
437 565	54	2	30	96	78	68

SS = Spanner size
SS = spanner size

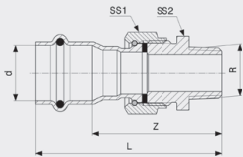

Sanpress Inox Adapter union
- steel non-corroding
Model 2365

article	VdS	d	R	Z	L	SS1	SS2
438 258		15	1/2	46	68	30	27
438 265		15	3/4	47	69	30	27
438 272		18	1/2	45	67	30	27
438 289		18	3/4	47	69	30	27
438 296	✓	22	1/2	53	76	30	27
438 302	✓	22	3/4	54	77	30	27
438 319	✓	22	1	54	77	37	34
438 326	✓	28	3/4	60	84	37	34
438 333	✓	28	1	62	86	37	34
438 340	✓	35	1 1/4	63	89	53	50
438 357	✓	42	1 1/2	65	101	60	55
438 364	✓	54	2	77	117	78	72

VdS = VdS certification
SS = Spanner size
SS = spanner size

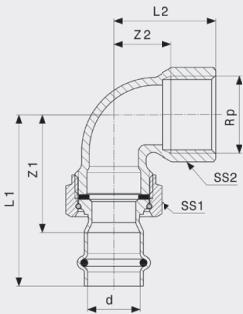

Sanpress Inox Adapter union 90°
- steel non-corroding
Model 2355

article	d	Rp	Z1	Z2	L1	L2	SS1	SS2
437 299	15	1/2	41	18	63	33	30	25
437 305	18	1/2	41	18	63	33	30	25
437 312	18	3/4	44	23	66	39	36	31
437 329	22	3/4	48	23	71	39	37	31
437 336	22	1	51	25	74	44	37	38
437 343	28	1	57	28	81	47	46	38
437 350	35	1 1/4	60	35	86	56	53	46
437 367	42	1 1/2	72	38	108	59	60	53
437 374	54	2	84	43	124	68	78	65

SS = Spanner size
SS = spanner size

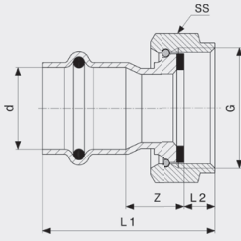

Sanpress Inox Connection screw fitting
- steel non-corroding
Model 2363

article	VdS	d	G	Z	L1	L2	SS
437 572		15	1/2	21	50	6	24
437 589		15	3/4	15	50	8	30
437 596		18	1/2	24	52	6	24
437 602		18	3/4	15	45	8	30
437 619	✓	22	3/4	22	54	8	30
437 626	✓	22	1	16	48	8	37
437 633	✓	28	1	24	56	8	37
437 640	✓	28	1 1/4	18	52	10	46
437 862	✓	35	1 1/2	18	55	10	53
437 893	✓	42	1 3/4	22	69	10	60
437 923	✓	42	2	24	74	14	66
437 947	✓	54	2 3/8	24	76	12	78
437 992	✓	54	2 1/2	26	81	16	84

VdS = VdS certification
SS = wrench size

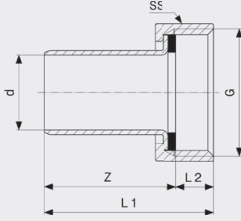

Sanpress Inox Connection screw fitting
- steel non-corroding
Model 2364

article	d	G	Z	L1	L2	SS
438 180	15	3/4	34	42	9	29
438 197	18	3/4	34	42	9	29
438 203	22	1	35	44	10	36
438 210	28	1 1/4	36	47	11	46
438 227	35	1 1/2	38	50	12	52
438 234	42	1 3/4	64	77	13	59
438 241	54	2 3/8	62	72	11	74

SS = wrench size

CAPS, PLUGS

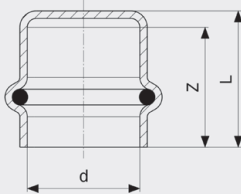

Sanpress Inox Cap
- steel non-corroding
Model 2356

article	d	Z	L
452 858	15	22	26
452 865	18	23	26
452 872	22	24	26
452 889	28	25	28
452 896	35	26	30
452 902	42	36	40
452 919	54	40	44

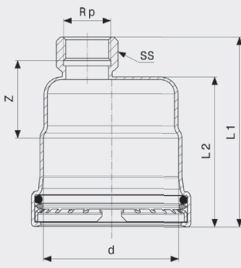

Sanpress Inox XL Cap
- steel non-corroding
Model 2356XL

article	d	Rp	Z	L1	L2	SS
578 183	64.0	3/4	39	99	78	30
557 874	76.1	3/4	39	105	84	30
557 898	88.9	3/4	39	105	84	30
557 911	108.0	3/4	38	115	94	30

SS = wrench size

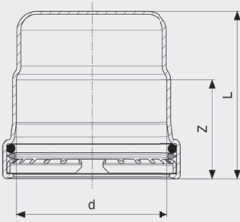

Sanpress Inox XL Cap
- steel non-corroding
Model 2356.1XL

article	d	Z	L
557 881	76.1	50	84
557 904	88.9	50	84
557 928	108.0	60	94

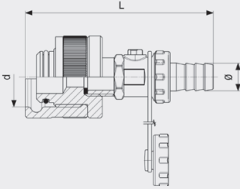

Forcing plug
- brass
Model 2269

article	d	L	Ø
290 801	12	117	14
141 523	15	120	14
289 423	18	120	14
140 557	22	119	14
142 568	28	131	14
144 111	35	119	14
144 999	42	123	14
187 798	54	127	14

Ø = diameter

FLANGES

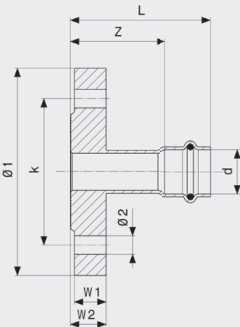

Sanpress Inox Flange adapter
- steel non-corroding
Model 2359

article	DN	d	Z	L	W1	W2	Ø1	k	Ø2	n
593 315	20	22	48	71	16	18	105	75	14	4
593 322	25	28	44	68	16	18	115	85	14	4
593 339	32	35	44	70	16	18	140	100	18	4
593 346	40	42	56	92	16	18	150	110	18	4
593 353	50	54	56	96	16	18	165	125	18	4

Ø = diameter

k = bolt circle diameter

Ø = diameter

n = number of holes

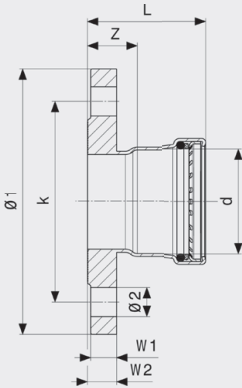

Sanpress Inox XL Flange adapter
- steel non-corroding
Model 2359XL

article	VdS	DN	d	Z	L	W1	W2	Ø1	k	Ø2	n
616 809		50	64.0	31	74	16	18	165	125	18	4
482 978	✓	65	76.1	29	79	16	18	185	145	18	8
482 985	✓	80	88.9	31	81	18	20	200	160	18	8
482 992	✓	100	108.0	32	92	18	20	220	180	18	8

VdS = VdS certification
Ø = diameter
k = bolt circle diameter
Ø = diameter
n = number of holes

WALL PLATES

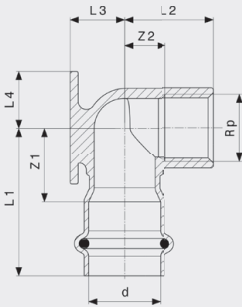

Sanpress Inox Wall plate
- steel non-corroding
Model 2325.5

article	d	Rp	Z1	Z2	L1	L2	L3	L4
437 244	15	1/2	25	11	47	26	12	18
437 251	18	1/2	23	11	45	26	14	18
437 268	22	1/2	23	13	46	28	17	18
437 275	22	3/4	26	13	49	30	17	20
437 282	28	1	30	16	54	36	20	23

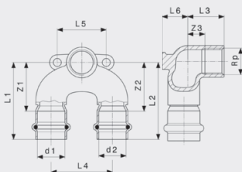

Sanpress Inox Double wall plate
- steel non-corroding
Model 2325.7

article	d1	Rp	d2	Z1	Z2	Z3	L1	L2	L3	L4	L5	L6
693 718	15	1/2	15	40	40	11	62	62	26	50	40	12

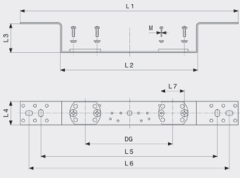

Mounting bracket
- galvanised steel
Model 2021.7

article	DG	L1	L2	L3	L4	L5	L6	L7	M
651 350	70/100/150	370	234	48	40	300	340	40	4

DG = depth gauge
M = thread type

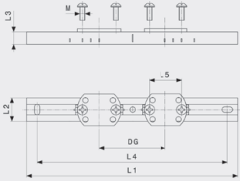

Mounting bracket
- galvanised steel
Model 2141.3

article	DG	L1	L2	L3	L4	L5	M
581 701	80-150	253	28	15	228	40	6

DG = depth gauge
M = thread type

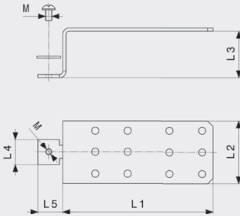

Mounting bracket
- galvanised steel
Model 2141.4

article	L1	L2	L3	L4	L5	M
586 706	140	58	43	24	23	6

M = thread type

COMPENSATORS

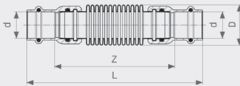

Compensator
Model 2251

article	d	Z	L	Ø
690 250	15	100	144	23
690 267	18	104	148	27
690 274	22	102	149	34
690 281	28	121	168	41
690 298	35	123	174	50
690 304	42	127	199	60
690 311	54	137	217	72

Ø = diameter

STAINLESS STEEL SHUT-OFF VALVES

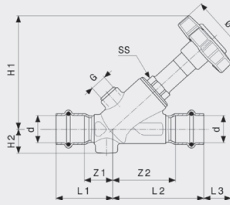

Easytop Inox Slanted seat valve
- steel non-corroding
Model 2337

article	DN	d	Z1	Z2	L1	L2	L3	H1	H2	G	Ø	SS
468 392	15	15	18	39	40	62	21	80	18	1/4	55	19
468 408	15	18	22	44	44	66	17	80	18	1/4	55	19
468 415	20	22	24	52	46	74	22	92	19	1/4	55	19
468 422	25	28	26	61	50	85	31	111	23	1/4	70	27
468 439	32	35	29	74	55	100	33	126	26	1/4	70	27
468 446	40	42	31	83	67	119	37	149	30	1/4	90	36
468 453	50	54	36	99	77	139	43	172	36	1/4	90	41

Ø = diameter

SS = wrench size

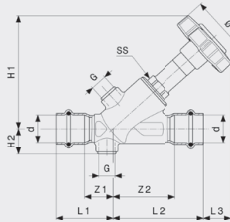

Easytop Inox CRV slanted seat valve
- steel non-corroding
Model 2338

article	DN	d	Z1	Z2	L1	L2	L3	H1	H2	SS	Ø	G
468 460	15	15	17	38	40	62	17	76	19	19	55	1/4
468 477	15	18	22	44	44	66	13	76	19	19	55	1/4
468 484	20	22	23	51	46	74	18	88	21	19	55	1/4
468 491	25	28	26	61	50	85	27	108	24	27	70	1/4
468 507	32	35	29	74	55	100	28	123	28	27	70	1/4
468 514	40	42	32	82	68	118	34	145	31	36	90	1/4
468 521	50	54	36	99	77	139	37	166	37	41	90	1/4

SS = wrench size

Ø = diameter

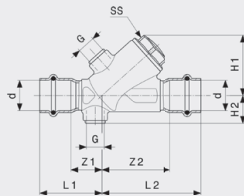

Easytop Inox Backflow preventer
- steel non-corroding
Model 2339

article	DN	d	Z1	Z2	L1	L2	H1	H2	SS	G
471 255	15	15	17	38	40	62	36	19	19	1/4
471 262	15	18	22	44	44	66	36	19	19	1/4
471 279	20	22	23	51	46	74	45	21	25	1/4
471 286	25	28	26	61	50	85	55	24	30	1/4
471 293	32	35	29	74	55	100	66	28	36	1/4
471 309	40	42	32	82	68	118	77	31	36	1/4
471 316	50	54	36	99	77	139	89	37	41	1/4

SS = wrench size

STAINLESS STEEL BALL VALVES

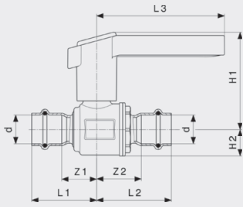

**Easytop Inox Ball valve
Model 2370**

article	DN	d	Z1	Z2	L1	L2	L3	H1	H2
554 729	15	15	16	22	40	47	98	73	17
554 736	15	18	22	29	44	51	98	73	17
554 743	20	22	27	34	50	57	98	74	20
554 750	25	28	29	39	53	63	112	89	24
554 767	32	35	37	44	63	70	112	100	30
554 774	40	42	47	46	83	82	119	125	37
554 781	50	54	50	55	90	96	119	133	45

FREE-FLOW AND STRAIGHT SEAT VALVES

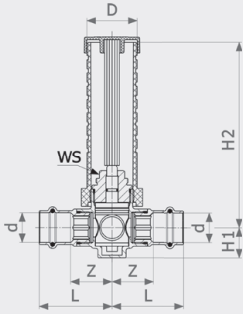

**Easytop Concealed free-flow valve
Model 2240**

article	d	ID	Z	L	H1	H2	SS	D
606 343	15	45-130	32	54	23	140	17	38
606 459	18	45-130	31	53	23	140	17	38
606 466	22	45-130	31	55	23	140	17	38

ID = installation depth
SS = wrench size
D = external diameter

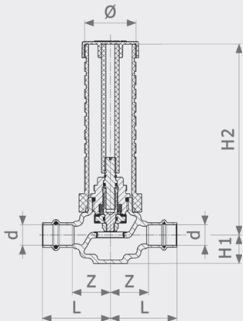

**Easytop Concealed straight seat valve
Model 2235**

article	DN	d	ID	Z	L	H1	H2	Ø
595 937	15	15	45-130	28	50	21	141	38
595 944	15	18	45-130	28	50	21	141	38
596 750	20	22	45-130	26	50	21	141	38
596 767	25	28	45-130	26	50	21	141	38

ID = installation depth
Ø = diameter

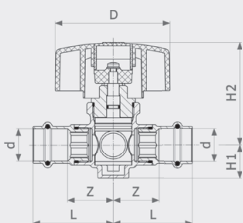

**Easytop Free-flow valve
Model 2242**

article	d	Z	L	H1	H2	D
606 312	15	32	54	23	70	79
606 329	18	31	53	23	70	79
606 336	22	31	55	23	70	79

D = external diameter

order code	page	order code	page	order code	page	order code	page	order code	page
140 557	17	436 056	6	436 872	12	437 626	16	482 657	5
141 523	17	436 063	6	436 889	12	437 633	16	482 664	5
142 568	17	436 070	6	436 896	12	437 640	16	482 671	5
144 111	17	436 155	13	436 902	12	437 862	16	482 688	5
144 999	17	436 162	13	436 919	12	437 893	16	482 695	5
187 798	17	436 179	13	436 926	12	437 923	16	482 701	5
193 294	6	436 186	13	436 933	12	437 947	16	482 718	7
193 324	6	436 193	13	436 940	12	437 992	16	482 725	7
193 331	6	436 209	13	436 957	12	438 180	16	482 732	7
288 068	10	436 216	13	436 964	12	438 197	16	482 749	7
289 010	6	436 223	14	436 971	12	438 203	16	482 756	7
289 423	17	436 230	14	436 988	12	438 210	16	482 763	7
290 801	17	436 247	14	436 995	12	438 227	16	482 770	7
298 876	10	436 254	14	437 008	12	438 234	16	482 787	7
298 883	10	436 261	14	437 015	12	438 241	16	482 794	7
303 815	11	436 278	14	437 022	12	438 258	15	482 800	13
303 822	11	436 285	14	437 039	12	438 265	15	482 817	13
304 744	11	436 292	14	437 046	12	438 272	15	482 824	13
317 423	10	436 308	14	437 053	12	438 289	15	482 831	14
317 430	10	436 315	14	437 060	12	438 296	15	482 848	14
317 447	10	436 322	14	437 077	12	438 302	15	482 855	14
317 454	10	436 339	14	437 091	13	438 319	15	482 862	9
317 508	10	436 346	14	437 107	13	438 326	15	482 879	9
331 528	11	436 353	14	437 114	13	438 333	15	482 886	9
435 363	5	436 360	14	437 121	13	438 340	15	482 893	9
435 370	5	436 377	13	437 138	13	438 357	15	482 909	9
435 387	5	436 384	13	437 145	8	438 364	15	482 916	9
435 394	5	436 391	13	437 152	8	445 973	8	482 923	9
435 400	5	436 407	13	437 169	8	445 980	8	482 930	9
435 417	5	436 414	13	437 176	8	445 997	8	482 978	18
435 424	5	436 421	13	437 183	8	446 000	8	482 985	18
435 431	5	436 438	13	437 190	8	446 017	8	482 992	18
435 448	5	436 445	9	437 206	8	446 024	8	483 005	7
435 639	4	436 452	9	437 213	8	446 031	8	483 012	7
435 646	4	436 469	9	437 220	8	449 506	8	483 029	7
435 653	4	436 476	9	437 237	8	452 469	6	483 036	7
435 660	4	436 483	9	437 244	18	452 506	6	483 043	7
435 677	4	436 490	9	437 251	18	452 858	16	483 050	7
435 684	4	436 506	9	437 268	18	452 865	16	483 067	7
435 691	4	436 513	9	437 275	18	452 872	16	483 074	7
435 707	4	436 520	9	437 282	18	452 889	16	483 081	7
435 714	4	436 537	9	437 299	15	452 896	16	483 098	7
435 721	4	436 544	9	437 305	15	452 902	16	483 104	7
435 738	4	436 551	9	437 312	15	452 919	16	483 111	7
435 745	4	436 568	9	437 329	15	452 926	6	483 128	9
435 752	4	436 575	10	437 336	15	452 933	6	483 135	14
435 769	4	436 582	10	437 343	15	452 940	6	483 142	14
435 776	5	436 599	10	437 350	15	468 392	20	483 159	14
435 783	5	436 605	10	437 367	15	468 408	20	483 166	14
435 790	5	436 612	10	437 374	15	468 415	20	483 173	14
435 806	5	436 629	10	437 381	14	468 422	20	483 180	14
435 813	5	436 636	10	437 398	14	468 439	20	554 729	21
435 837	6	436 643	10	437 404	14	468 446	20	554 736	21
435 844	6	436 650	10	437 411	14	468 453	20	554 743	21
435 851	6	436 667	10	437 428	14	468 460	20	554 750	21
435 868	6	436 674	10	437 435	14	468 477	20	554 767	21
435 875	6	436 681	10	437 442	14	468 484	20	554 774	21
435 882	6	436 704	11	437 459	15	468 491	20	554 781	21
435 899	6	436 711	11	437 466	15	468 507	20	557 874	16
435 905	6	436 728	11	437 473	15	468 514	20	557 881	17
435 912	6	436 735	11	437 480	15	468 521	20	557 898	16
435 929	6	436 742	11	437 497	15	471 255	20	557 904	17
435 936	6	436 759	11	437 503	15	471 262	20	557 911	16
435 943	6	436 766	11	437 510	15	471 279	20	557 928	17
435 950	6	436 773	11	437 527	15	471 286	20	566 678	11
435 967	6	436 780	11	437 534	15	471 293	20	566 685	11
435 974	6	436 797	12	437 541	15	471 309	20	566 692	11
435 981	6	436 803	12	437 558	15	471 316	20	566 708	11
435 998	6	436 810	12	437 565	15	482 596	4	577 988	4
436 001	6	436 827	12	437 572	16	482 602	4	577 995	4
436 018	6	436 834	12	437 589	16	482 619	4	578 008	5
436 025	6	436 841	12	437 596	16	482 626	4	578 015	5
436 032	6	436 858	12	437 602	16	482 633	4	578 022	7
436 049	6	436 865	12	437 619	16	482 640	4	578 039	7

order code	page	order code	page	order code	page	order code	page	order code	page
578 046	7								
578 053	7								
578 060	7								
578 077	7								
578 084	13								
578 091	14								
578 107	14								
578 114	14								
578 121	14								
578 138	14								
578 145	9								
578 152	9								
578 183	16								
581 701	19								
586 706	19								
588 328	10								
588 564	10								
593 315	17								
593 322	17								
593 339	17								
593 346	17								
593 353	17								
593 360	7								
593 377	7								
593 384	7								
595 937	21								
595 944	21								
596 750	21								
596 767	21								
605 490	10								
605 506	10								
605 513	10								
605 520	10								
606 312	21								
606 329	21								
606 336	21								
606 343	21								
606 459	21								
606 466	21								
616 809	18								
619 954	10								
619 961	10								
619 978	10								
619 985	9								
646 554	11								
646 561	11								
646 578	11								
646 585	11								
646 592	11								
646 608	11								
646 615	11								
646 622	11								
646 707	11								
646 714	11								
646 721	11								
646 738	11								
646 745	11								
646 752	11								
646 769	11								
646 776	11								
646 783	11								
646 790	11								
651 350	19								
690 250	19								
690 267	19								
690 274	19								
690 281	19								
690 298	19								
690 304	19								
690 311	19								
693 718	18								

model no.	page	model no.	page	model no.	page	model no.	page	model no.	page
2021.7	19								
2113	11								
2141.3	19								
2141.4	19								
2209.3	6								
2213	10								
2213P	10								
2215.6	10								
2235	21								
2240	21								
2242	21								
2251	19								
2269	17								
2311	9								
2311.1	11								
2311XL	9								
2312	10								
2312.1	12								
2312XL	10								
2314	12								
2314.2	12								
2314.5	13								
2315	13								
2315.1	14								
2315.1XL	14								
2315.5	13								
2315.5XL	14								
2315XL	13								
2316	4								
2316.1	4								
2316.1XL	4								
2316XL	4								
2317.1	8								
2317.2	8								
2317.2XL	9								
2318	6								
2318XL	7								
2325.5	18								
2325.7	18								
2326	5								
2326.1	5								
2326.1XL	5								
2326XL	5								
2327	6								
2337	20								
2338	20								
2339	20								
2355	15								
2356	16								
2356.1XL	17								
2356XL	16								
2359	17								
2359XL	18								
2360	14								
2362	15								
2363	16								
2364	16								
2365	15								
2370	21								
5313	11								
5313P	11								